



### 快速入门指南 Quick Start Guide

ANYWHERE

简体中文 1/10

### 接口说明

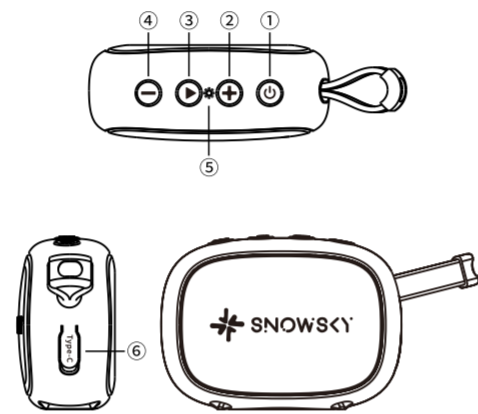

1. 电源键: 长按2秒开/关机, 短按3次进入TWS双音箱组队配对。
2. 音量+键: 短按音量+, 长按2秒上一曲。
3. 播放键: 短按播放/暂停, 长按3秒强制进入配对。
4. 音量-键: 短按音量-, 长按2秒下一曲。
5. 指示灯: 指示工作状态。
6. Type-C充电口: 接入5V充电器进行充电。

### 功能操作说明

#### 开关机:

长按电源键2秒开/关机。

#### 蓝牙配对:

- ① 出厂首次开机或清除配对信息后再次开机, 自动进入配对状态。
- ② 有配对过, 开机自动回连15秒, 如未回连成功自动进入配对状态。
- ③ 关机状态下, 长按开机键5秒开机进入强制配对状态。
- ④ 连接状态下, 长按播放键3秒进入强制配对状态。
- ⑤ 连接状态下, 同时按住音量+/-键2秒清除所有配对信息。

#### TWS组队蓝牙配对:

短按3次电源键后靠近已开机的另一只音箱。

#### 调节音量:

短按音量+键增加一级音量, 短按音量-键减小一级音量。

#### 音乐换曲:

长按2秒音量+键切换上一曲, 长按2秒音量-键切换下一曲。

#### 播放/暂停:

在播放状态下, 短按播放键将暂停, 在暂停状态下短按播放键将播放。

### 指示灯说明

状态	指示灯状态
开机	蓝灯长亮2秒
关机	红灯长亮2秒
配对中	红蓝灯交替闪烁
已连接	蓝灯常亮
TWS组队配对	蓝灯闪烁
TWS组队成功	主音箱 (L) 蓝灯长亮, 副音箱 (R) 蓝灯每5秒闪烁一次
低电量提示	红灯每10秒闪烁一次
低电量关机	红灯长亮2秒

简体中文 2/10

简体中文 3/10

充电中	红灯长亮
充满电	蓝灯常亮

### 注意事项

- ★请使用标准的USB电源适配器进行充电。
- ★当长期不使用本产品时, 需定期对本产品进行充电, 以避免电池损坏。
- ★使用本产品时请确认合适的音量, 以保护听力。
- ★请勿将本产品接触液体溶液, 以防止造成设备严重损坏。
- ★请勿将设备置于温度过高或过低 (45°C以上或0°C以下) 的环境中或使用或存放。
- ★请勿将设备置于汽车内等密闭高温环境中使用或存放。
- ★请勿将电池置于高温环境中, 电池浸水后禁止使用。
- ★禁止拆解、撞击、挤压、刺破电池或将电池投入火中。

### 了解更多

了解产品详细使用说明请访问:  
<http://www.fiio.com/supports>

欢迎扫描二维码访问:



- 由于产品不断改进, 各项规格及设计随时更改, 恕不另行通知。

简体中文 4/10

### 环保材料说明

部件名称	产品中有害物质的名称及含量					
	铅 (Pb)	汞 (Hg)	镉 (Cd)	六价铬 (Cr,VI)	多溴联苯 (PBB)	多溴二苯醚 (PBDE)
PCB	X	O	O	O	O	O
PCBA 焊点	X	O	O	O	O	O
元器件	X	O	O	O	O	O
显示屏*	X	O	O	O	O	O
电池*	X	O	O	O	O	O
外观件	O	O	O	O	O	O
配件*	X	O	O	O	O	O

注: 表中标记“X”的部件, 因全球技术发展水平限制而无法实现有害物质的替代, 带“\*”号部件表示如果在您所购买的产品中无该部件, 请忽略表中该部件信息。  
O: 表示该有害物质在该部件所有均质材料中的含量均在GB/T 26572-2011规定的限量要求以下。  
X: 表示该有害物质至少在该部件的某一均质材料中的含量超出GB/T 26572-2011规定的限量要求。

根据中国电子行业标准SJ/T 11364-2014 和相关的中国政府法规, 本产品及其某些内部或外部组件上可能带有环保使用期限标识。取决于组件和组件制造商, 产品及其组件上的使用期限标识可能有所不同。组件上的使用期限标识优先于产品上任何与之相冲突的或不同的环保使用期限标识。

10 此环保使用期限只适用于产品在规定的条件下工作

- 由于产品不断改进, 各项规格及设计随时更改, 恕不另行通知。

English 9/10

### WEEE Directive & Product Disposal

At the end of its serviceable life, this product should not be handed as household or general waste. It should be handed over to the applicable collection point for the recycling of electrical and electronic equipment, or returned to the supplier for disposal.

#### Internal/Supplied Batteries:

This symbol on the battery indicates that the battery is to be collected separately. This battery is designed for separate collection at an appropriate collection point.

Herby, Guangzhou FIO Electronics Technology Co., Ltd declares that this device is in compliance with Directive 2014/53/EU. The full text of the EU declaration of conformity is available at: [www.fiio.com/doc](http://www.fiio.com/doc)

Function	Frequency	Maximum output power
Bluetooth	2402-2480MHz	4dBm



简体中文 4/10

English 5/10

### Buttons and Ports Labeled

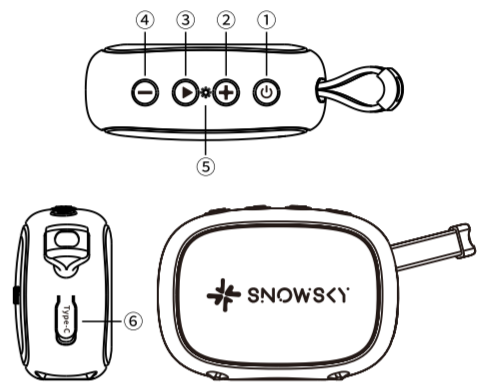

1. Power button: Long press for 2 seconds to power on/off; short press three times to enter TWS dual speaker pairing mode.
2. Volume up button: Short press to increase volume; long press for 2 seconds to switch to the previous track.
3. Play button: Short press to play/pause; long press for 3 seconds to force pairing.
4. Volume down button: Short press to decrease volume; long press for 2 seconds to switch to the next track.
5. Indicator light: Indicates the working status.
6. Type-C charging port: Connect to a 5V charger for charging.

English 6/10

### Operation Instructions

#### Power on/off:

Long press the power button for 2 seconds to power on/off.

#### Bluetooth pairing:

- ① The first time the device is powered on or powered on after clearing pairing records, it will automatically enter pairing mode.
- ② If previously paired, the device will start reconnecting for 15 seconds upon powering on. If the reconnection fails, it will automatically enter pairing mode.
- ③ To force the device to enter pairing mode, long press the power button for 5 seconds while the device is off.
- ④ To force the device to enter pairing mode, long press the play button for 3 seconds in the connecting state.
- ⑤ To clear all pairing records, long press both the volume up and volume down buttons for 2 seconds in the connecting state.

#### TWS Bluetooth pairing:

Short press the power button three times, and then bring it close to the other powered-on speaker.

#### Volume adjustment:

Short press the volume up button to increase the volume by one level; short press the volume down button to decrease the volume by one level.

#### Song switching:

Long press the volume up button for 2 seconds to switch to the previous track; long press the volume down button for 2 seconds to switch to the next track.

#### Play/Pause:

While playing, short press the play button to pause; while paused, short press the play button to resume playback.

English 7/10

### Indicator light explanations

Status	Indicator light status
Power on	Blue light keeps on for 2 seconds
Power off	Red light keeps on for 2 seconds
Pairing	Red and blue lights flash alternately
Connected	Blue light keeps on
TWS pairing	Blue light flashes
TWS pairing successful	Blue light on the main speaker (L channel) keeps on, and blue light on the secondary speaker (R channel) flashes every 5 seconds
Low battery alert	Red light flashes every 10 seconds
Low battery shutdown	Red light keeps on for 2 seconds
Charging	Red light keeps on
Fully charged	Blue light keeps on

### Notes and Precautions

- ★ Please use a standard USB power adapter to charge the device.
- ★ Please charge the battery on a regular basis to avoid any damage if it has not been used for a long time.
- ★ Please adjust the volume to a suitable level before using this product so as to protect your hearing.
- ★ Please keep the device away from liquids to avoid any damage to it.
- ★ Please do not use or place the device in circumstances of excessive high/low temperatures (above 45°C or below 0°C).
- ★ Please do not use or place the device in an enclosed high-temperature environment, such as in a car.

English 8/10

- ★ Please do not put the battery in a high-temperature environment. The battery is prohibited from use if it is soaked in water.
- ★ Please do not disassemble, hit, crush, or puncture the battery, and do not put it on fire.

### To learn more

To learn more about the product, please visit our website:  
<http://www.fiio.com/supports>

Scan the QR code to visit:



FIO website FIO facebook

- Due to continuous improvement, each specification and design are subject to change at any time without further notice.

English 10/10

### FCC NOTICE

This equipment has been tested and found to comply with the limits for a Class B digital device, pursuant to Part 15 of the FCC Rules. These limits are designed to provide reasonable protection against harmful interference in a residential installation. This equipment generates, uses and can radiate radio frequency energy and, if not installed and used in accordance with the instructions, may cause harmful interference to radio communications. However, there is no guarantee that interference will not occur in a particular installation. If this equipment does cause harmful interference to radio or television reception, which can be determined by turning the equipment off and on, the user is encouraged to try to correct the interference by one or more of the following measures:

- Reorient or relocate the receiving antenna.
- Increase the separation between the equipment and receiver.
- Connect the equipment into an outlet on a circuit different from that to which the receiver is connected.
- Consult the dealer or an experienced radio/TV technician for help. The equipment complies with FCC radiation exposure limits set forth for an uncontrolled environment. The equipment should be installed and operated with minimum distance 20 cm between the radiator & your body.

广州飞傲电子科技有限公司  
Guangzhou FIO Electronics Technology Co., Ltd.