

GREEN[®] POWER

DATA SHEET
Model: GP 6-235

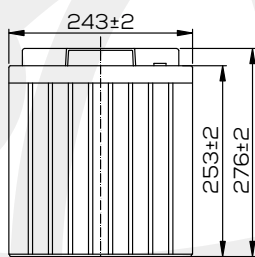

SIDE 1

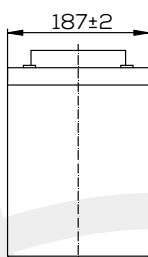

SIDE 2

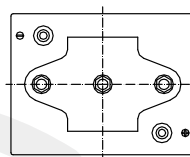

SUPERIOR

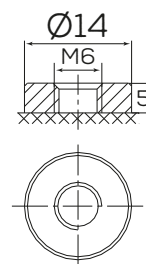

Terminal F11

SIZE AND WEIGHT		POLES	
Lenght	243 ± 2mm (9,57 inch)	Type	F11
Width	187 ± 2mm (6,73 inch)	Material	Copper
Height	253 ± 2mm (9,96 inch)	OPERATING VOLTAGE	
Total Height	276 ± 2mm (10,87 inch)	Maintenance	From 6,80 a 6,90 V
Approximate weight	32 kg (70,54 lbs) ±3%	Charging (cyclic)	From 7,30 a 7,40 V
STRUCTURE AND TECHNOLOGY		OPERATING CURRENT	
Technology	AGM battery	Charge (MAX)	70 A
External case	ABS UL94-HB		
NOMINAL VOLTAGE		NOMINAL TEMPERATURE	
6 V		25°C ± 3°C (77°F ± 37,4°F)	
CAPACITY (25°C)		WORKING TEMPERATURE	
20HR(5,40 V)	235 Ah	Discharge	-20°C~60°C (-4°F~140°F)
10HR(5,25 V)	222,0 Ah	Charge	-10°C~50°C (14°F~122°F)
5HR(4,80 V)	196,4 Ah	Storage	-20°C~60°C (-4°F~140°F)
INTERNAL RESISTANCE (FULL CHARGE, 25°C)			

Approx. 1,9m Ω

This data sheet is indicative only. NDS Energy reserves the right to make changes for technical or commercial reasons to the products shown at any time without prior notice.

Date of last update: 03/06/2019

CONSTANT DISCHARGE CURRENT RATINGS (A, 25°C)

F.V/ TIME	10 MIN	15 MIN	30 MIN	60 MIN	2H	3H	4H	5H	8H	10H	20H
4,80 V	-	367	222	138	80,4	56,1	46,0	39,3	26,9	22,4	11,9
4,95 V	-	358	218	136	79,9	55,8	45,7	39,0	26,8	22,4	11,8
5,10 V	-	345	211	132	79,2	55,4	45,4	38,8	26,6	22,3	11,8
5,25 V	-	333	206	130	78,0	55,0	45,1	38,5	26,4	22,2	11,7
5,40 V	-	315	198	126	76,0	53,4	43,7	37,3	25,6	22,0	11,7

DISCHARGING DETAILS

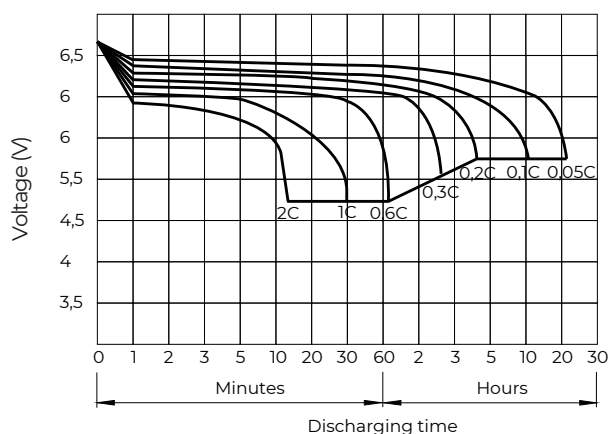

CHARGING DETAILS

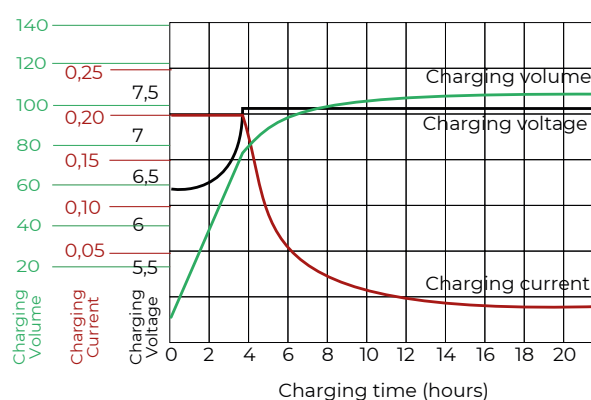

Test conditions:

- Discharge: 100%
- Charging Current: 0,20 CA
- Charging Voltage: 2,40V/cell
- Temperature: 25°C

SELF-DISCHARGE

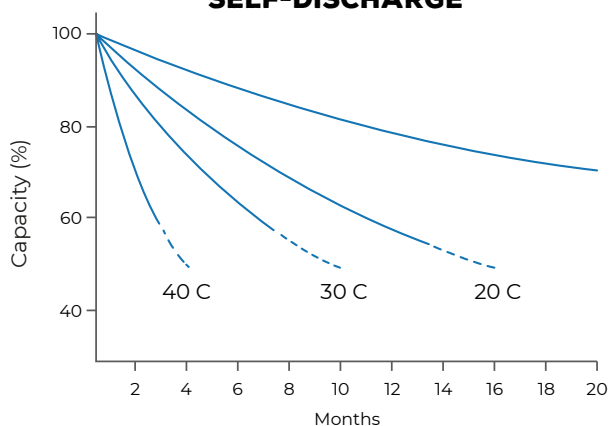

LIFE CYCLE RELATED TO DEPTH OF DISCHARGE

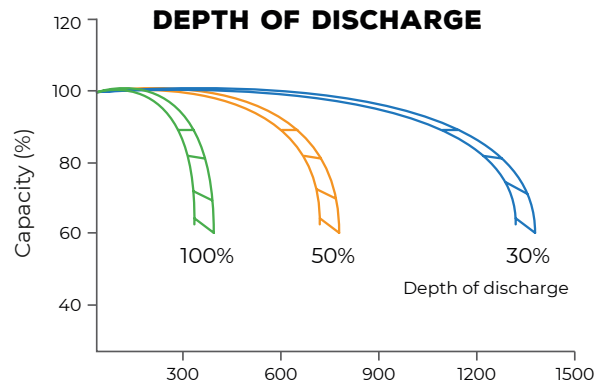

This data sheet is indicative only. NDS Energy reserves the right to make changes for technical or commercial reasons to the products shown at any time without prior notice.

Date of last update: 03/06/2019



TUTTA L'ENERGIA CHE TI SERVE
ALL THE ENERGY YOU NEED