

* ATTENTION! BEFORE PROCEED



If you have this Radio display (see the picture), with FIAT frame code 735631261, you also need to buy the FIAT frame code:

- for black frame: FIAT code 735628518

- for ivory frame: FIAT code 735628513

with this frame you can proceed to the installation by using this manual.

Facia plate installation kit for:

FIAT

Model: 500*

Year: 2016>

Kit content: double DIN facia plate
mounting brackets + screws

Compatibility: Compatible with double DIN device

Customer code: CA-HM-FIA.011



INSTALLATION MANUAL



1 This is how the original dashboard looks like.



5 Fix the supplied brackets on the supplied fascia plate as shown in the picture.

2 Remove and save the original plastic part as shown in the picture A. Remove and save the screws shown in the pictures B and C. Remove and save the original plastic part as shown in the picture C.

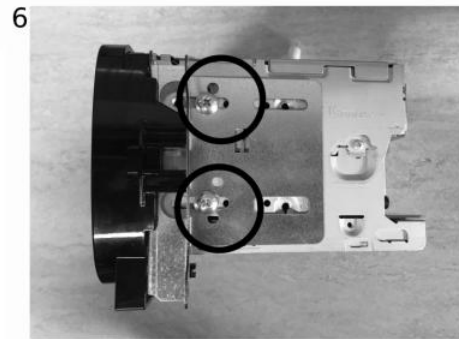
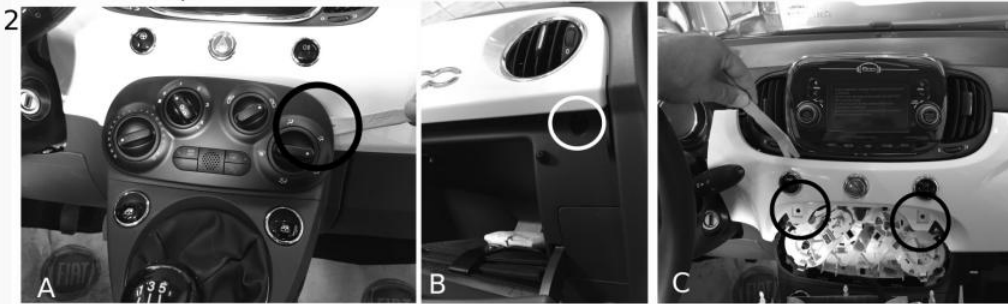

6 Take the new head-unit and fix the fascia plate with the brackets as shown.



3 Unscrew, remove and save the dashboard air-vents as shown in the picture.

7 7 Insert the head-unit in the radio tunnel and put back in place the air-vents and the two plastic parts which were previously removed.



4 Unscrew and remove the head-unit from the dashboard and save the screws.

Shorten of 7 mm the four plastic flaps, circled in the picture, at the bottom of the radio tunnel.



8 This is the final result.