



VIRTUS_{nano} 603 / VIRTUS_{nano} 602

2-Way / 3-Way Slim Component System Installation Guide

VIRTUS PACKAGE CONTENT

6" WOOFER



MT120N TWEETER

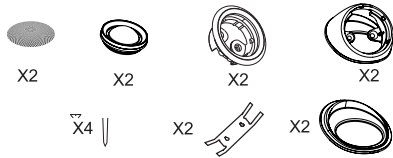

2-WAY / 3-WAY CROSSOVER

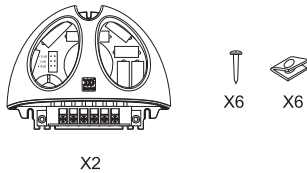

CDM600 MIDRANGE (IN 3-WAY ONLY)

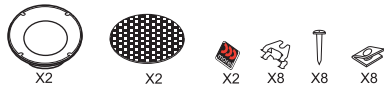

WOOFER & CROSSOVER MOUNTING

6" UNIT MOUNTING

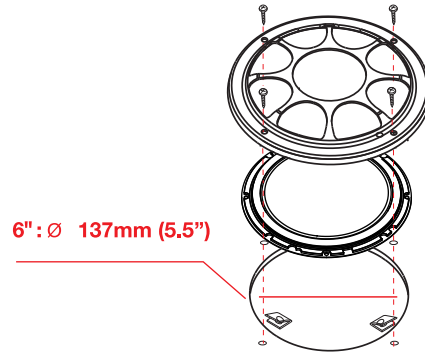

CROSSOVER MOUNTING

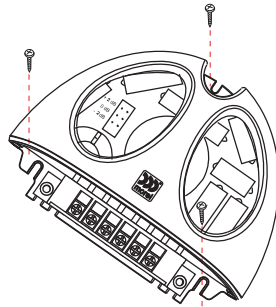

TWEETER MOUNTING

FLUSH MOUNTING

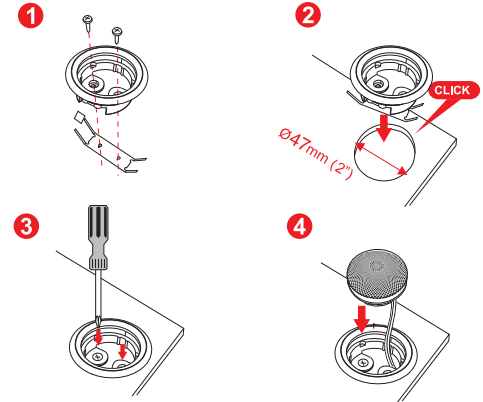

SURFACE MOUNTING

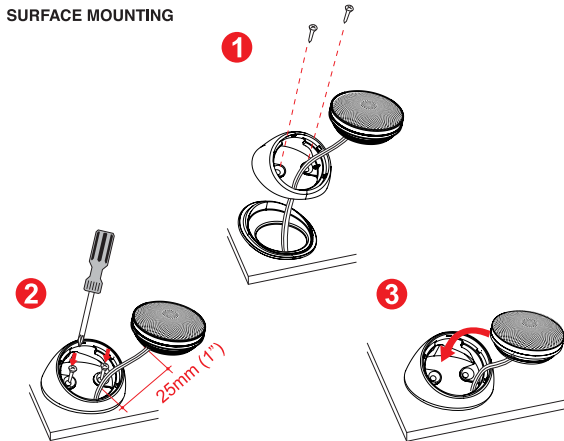

2-WAY CROSSOVER WIRING

PASSIVE SET UP

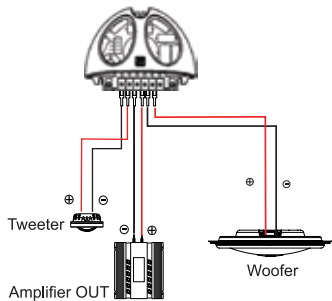

ACTIVE SET UP (Outputs must be filtered)

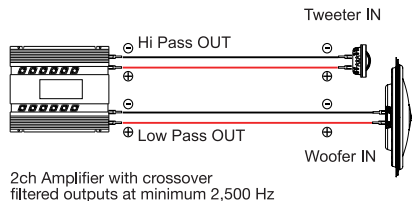

TWEETER LEVEL ALIGNMENT

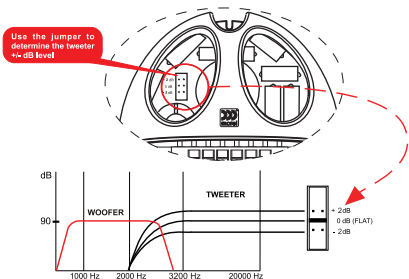

3-WAY CROSSOVER WIRING

PASSIVE SET UP

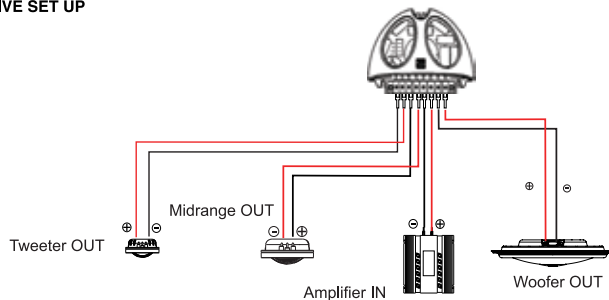

ACTIVE SET UP (Outputs must be filtered)

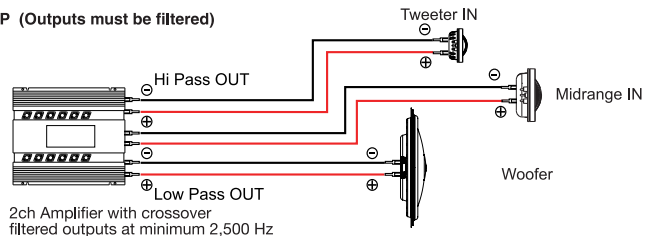

CDM600 MIDRANGE MOUNTING (IN 3-WAY ONLY)

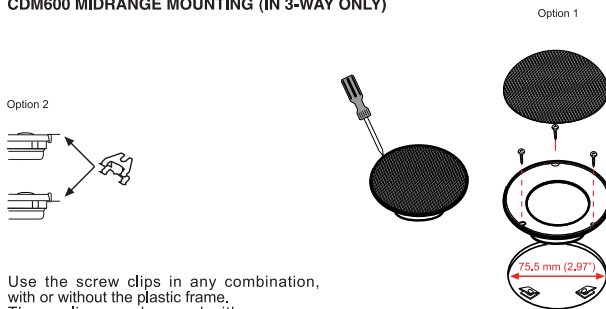

Use the screw clips in any combination, with or without the plastic frame. These clips can be used either way up down depending on installation requirements.

SPECIFICATIONS

WOOFERS	VIRTUS MW6
Nominal Impedance (Ohms)	4
Power Handling Wrms	80
Max. Trans.Pwr Handling Wrms	250
Sensitivity (2.83V/1M)	91dB
Frequency Response Hz	50-3500
Resonant Freq. Fs Hz	85
Voice Coil Diameter mm (inch)	54 (2.16)
Voice Coil Height mm (inch)	10 (0,4)
Voice Coil Type/ Former	Aluminum
Voice Coil Wire	Hexatech™ 100% Aluminum
DC Resistance (Ohms)	3
Voice Coil Induct. @1 kHz (MH)	0,28
Magnet System	Neodymium Vented
HE-Magnetic Gap Height mm (inch)	4 (0,16)
BL Product/BXL	4,4
Max. Linear Ex./Xmax mm (inch)	±3 (0,12)
Electrical Q Factor QES	1,4
QTS	0,9
QMS	3,2
Moving Mass MMS - gr/ ounce	17
Equiv. Can Air Load VAS - L (cu.ft)	5,5
Effective Piston Area SD sq.cm (sq. inch)	141cm ²
Cone Type	Treated Paper Cone
Cone Material	Carbon + Paper
Unit Diameter mm (inch)	6,5 (0,26)
Mounting Depth mm (inch)	17 (0,7)
Mounting Cutout mm (inch)	137 (5,48)
Net Weight gr.	450

MIDS & TWEETERS	CDM600	MT120N
Nominal Impedance (ohm)	8	4
Power Handling (Wrms)	100	80
Max Transient Power Handling W (10ms)	300	250
Sensitivity (2.83V/1M) dB	90	90
Frequency Response Hz	600-6000	1800-22000
FS Hz	480	1200
Voice Coil Diameter mm (inch)	54 (2.125)	28 (1.125)
Voice Coil Former	Aluminum	Aluminum
Voice Coil Wire	Hexatech™ Aluminum	Copper
DC Resistance ohm	3,5	3,4
Magnet System	Neodymium Rear Vented	Neodymium
Dome Type	Selected soft dome	Acuflex Coated Dome
Dome Material	Silk	Silk
Unit Diameter mm (inch)	88.00 (3,50)	45.00 (1,8)
Mounting Depth mm (inch)	21.00 (0,83)	20.00 (0,80)
Mounting Cutout mm (inch)	75.50 (2,97)	50.00 (2,00)
Net Weight Kg(lb)	0,25 (0,55)	0,06 (0,13)

CROSSOVERS	MXR240n	MXR300,2
Crossover Point	2200Hz/12dB/6dB	W: 500Hz / 12dB M:18dB/ 2200Hz/ 12dB T: 2200Hz / 6dB
Crossover Controls	Tweeter+/- 2dB	Tweeter+/- 2dB
Wiring Options	N/A	N/A

* Morel operates a policy of continuous products design improvement, consequently specifications are subject to alteration without prior notice.

