

# ACCESS 100 AC

## 2-way coaxial kit

- (DFS®) Dual Fiberglass Structure cone  
**High resistance (Power, climatic conditions, humidity...)**
- Grilles new design  
**Profiled**

- Butyl surround  
**Longlife**
- Tilted tweeter on rotativ pod  
**Optimization of the sound stage**

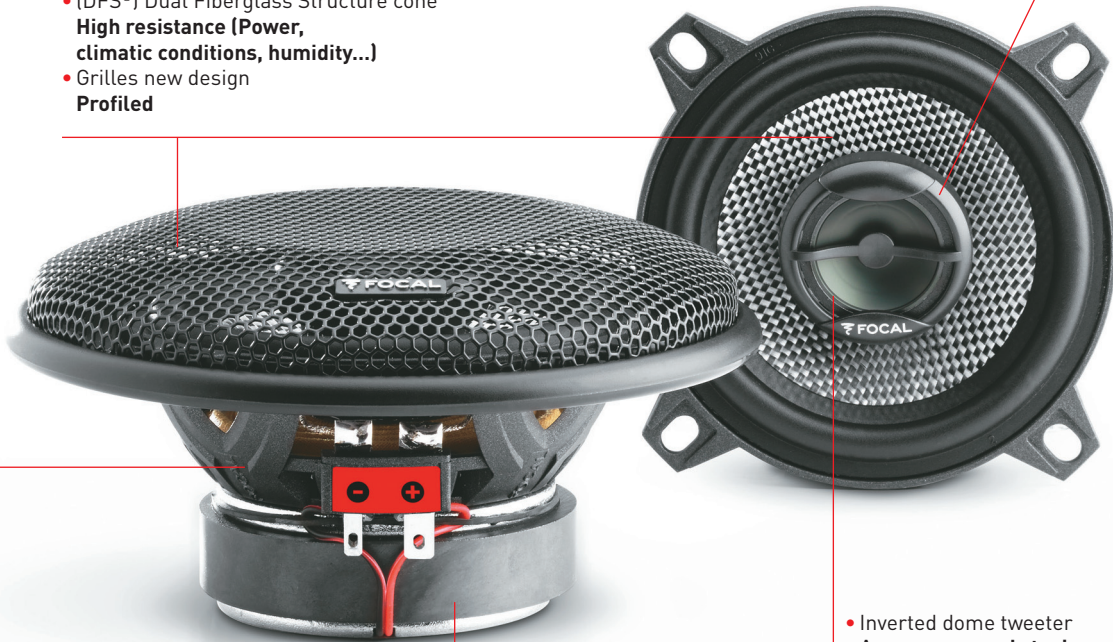

- ABS basket with 20% of fiberglass  
**Non magnetic, non resonant**
- 25mm (1") voice coil (2 Kapton® layer)  
**High power handling**

- 72mm magnet  
**High sentivity**
- Integrated crossover (4.7 kHz)  
**Easy and quick installation**

- Inverted dome tweeter  
**Accuracy, sound staging optimization**

## WHAT MAKES THE DIFFERENCE

- Cone DFS® (Dual fiberglass Structure)  
(climatic and power) high resistance
- Compact basket
- Rotativ tweeter

## TECHNICAL CHARACTERISTICS

**Woofer:** 4" (100mm)

**Voice-coil diameter:** 1" (25mm)

**Voice-coil height:** 0<sup>7</sup>/<sub>16</sub>" (11mm)

**Magnet:** 2<sup>13</sup>/<sub>16</sub>" (72mm)

**Tweeter:** Aluminum inverted dome

**Crossover:** (4,7Khz) 6dB/oct

**Max. power:** 80 Watts

**Nom. power:** 40 Watts RMS

**Sensitivity (2.83V/1m):** 87.2dB

**Frequency response:** 70Hz – 20kHz

**Accessories:** Supplied grilles

 **Performance**  
CREATE YOUR SOUND

 **FOCAL**  
THE SPIRIT OF SOUND

# ACCESS 100 AC

Woofer (4")



- Cone DFS®
- ABS basket
- TN43 inverted dome tweeter

## SPECIFICATIONS

Nominal power	40W	
Maximum power	80W	
Sensitivity (2,83V/1m)	87.2dB	
Cone	Glass fiber	
Surround	Butyl	
Nom. impedance	4 Ohms	
DC resistance	3.4 Ohms	
VC diameter	25mm	1"
VC height	10mm	0 <sup>3/8</sup> "
Former	Kapton	
Layers	2	
Wire	Copper	
Inductance	-	
Xmax	± 2.5mm	0 <sup>1/8</sup> "
Magnet d x h	72mm x 15mm	2 <sup>13/16</sup> x 0 <sup>9/16</sup> "
Magnet weight	160g	0.32 lbs
Flux density	0.9T	
Gap height	6mm	0 <sup>1/4</sup> "
Net weight	0.6kg	1.2 lbs

## FREQUENCY RESPONSE/IMPEDANCE

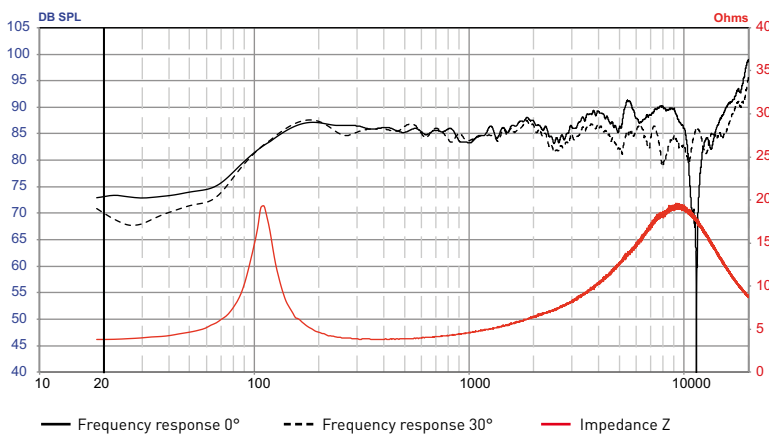

## PARAMETERS

Fs	110.12Hz
Vas	1.07 liters
Qts	0.824
Qes	0.96
Qms	5.82
Re	3.4 Ohms
Sd	52.81cm <sup>2</sup>
Cas	7.6E-09 m <sup>5</sup> /N
Mas	275.02kg/m <sup>4</sup>
Ras	32695,15 Ohms.ac
Cms	272µm/N
Mms	7.7g
Rms	0.912kg/s
Ces	406.88mF
Les	5.13mH
Res	20.67 Ohms
BI	4.34N/A
SPL	83.5 dB/W/m

## MECHANICAL DRAWING

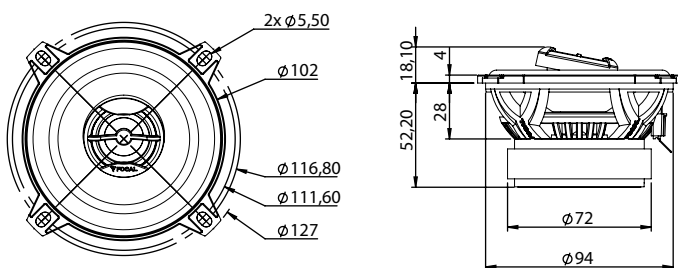

**Performance**  
CREATE YOUR SOUND

**FOCAL**  
THE SPIRIT OF SOUND