

ACCESS 130 AC

2-way coaxial kit

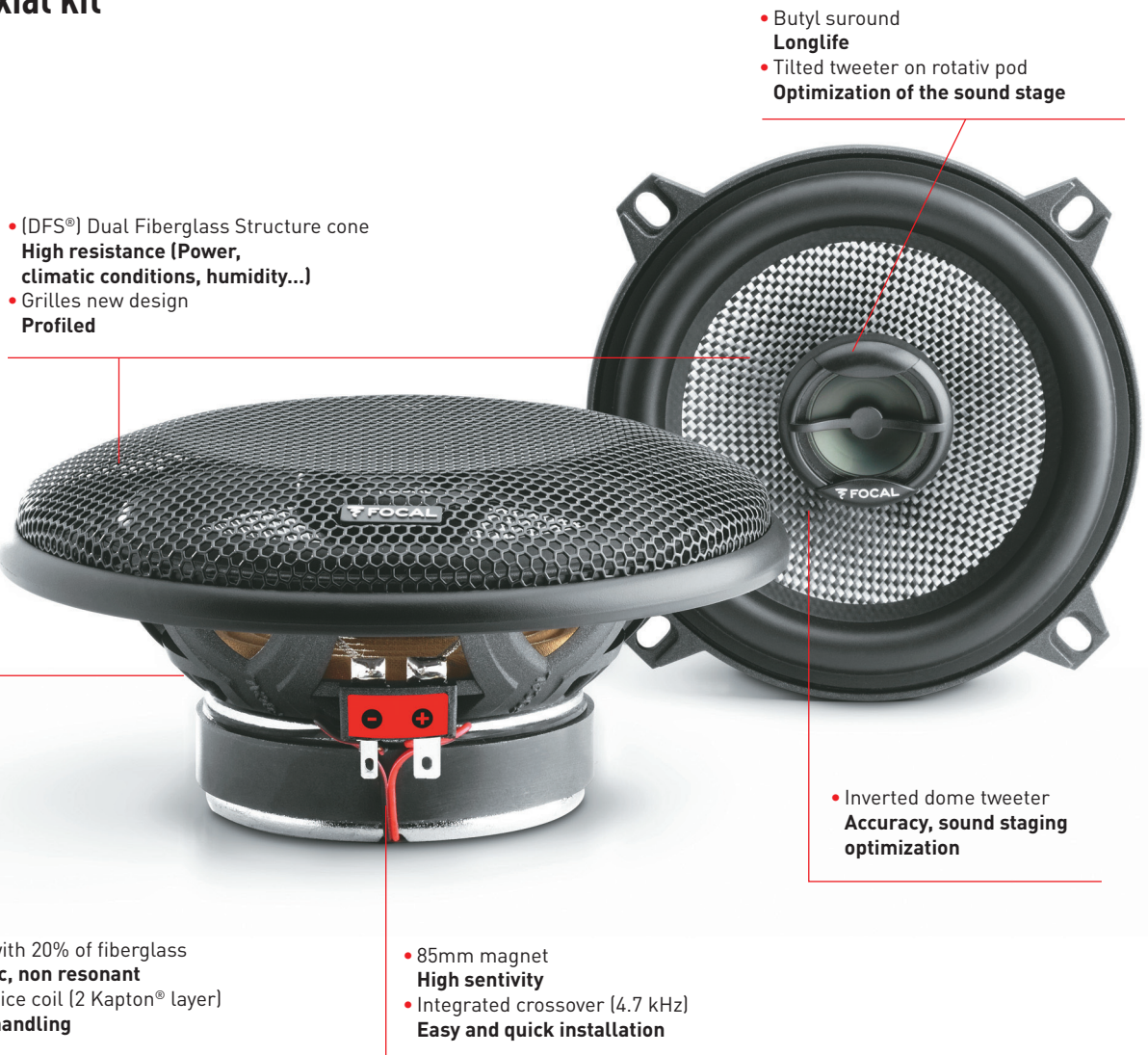

WHAT MAKES THE DIFFERENCE

- Cone DFS® (Dual fiberglass Structure)
(climatic and power) high resistance
- Extremely dynamic sound
- Rotativ tweeter

TECHNICAL CHARACTERISTICS

Woofer: 5" (130mm)

Voice-coil diameter: 1" (25mm)

Voice-coil height: 0⁷/₁₆" (11mm)

Magnet: 3¹/₃" (85mm)

Tweeter: Aluminum inverted dome

Crossover: (4,7Khz) 6dB/oct

Max. power: 100 Watts

Nom. power: 50 Watts RMS

Sensitivity (2.83V/1m): 89.3dB

Frequency response: 70Hz – 20kHz

Accessories: Supplied grilles

 **Performance**
CREATE YOUR SOUND

 **FOCAL**
THE SPIRIT OF SOUND

ACCESS 130 AC

Woofer (5")



- Cone DFS®
- ABS basket
- TN43 inverted dome tweeter

SPECIFICATIONS

Nominal power	50W	
Maximum power	100W	
Sensitivity (2,83V/1m)	89.3dB	
Cone	Glass fiber	
Surround	Butyl	
Nom. impedance	4 Ohms	
DC resistance	3.6 Ohms	
VC diameter	25mm	1"
VC height	11mm	0 ^{7/16} "
Former	Kapton	
Layers	2	
Wire	Copper	
Inductance	-	
Xmax	± 2.5mm	0 ^{1/8} "
Magnet d x h	85mm x 32mm	3 ^{1/3} x 1 ^{1/4} "
Magnet weight	380g	0.76 lbs
Flux density	1T	
Gap height	5mm	0 ^{3/16} "
Net weight	0.85kg	1.70 lbs

FREQUENCY RESPONSE/IMPEDANCE

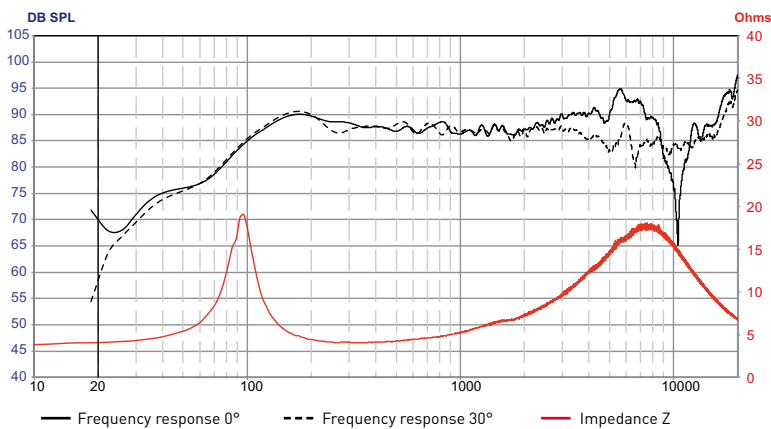

PARAMETERS

Fs	96.07Hz
Vas	2.85 liters
Qts	0.799
Qes	0.96
Qms	4.75
Re	3.6 Ohms
Sd	86.59cm ²
Cas	2,03E-08 m5/N
Mas	135.11kg/m ⁴
Ras	17169,06 Ohms.ac
Cms	271µm/N
Mms	10.13g
Rms	1.287kg/s
Ces	438.12mF
Les	6.26mH
Res	17.96 Ohms
BI	4.81N/A
SPL	86.05 dB/W/m

MECHANICAL DRAWING

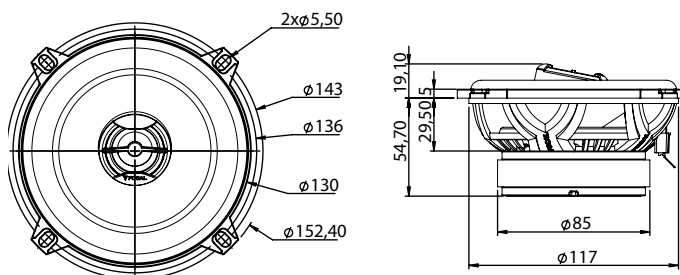

Performance
CREATE YOUR SOUND

FOCAL
THE SPIRIT OF SOUND