

UNIVERSAL ISS 690

Woofer



- Polyglass cone
- Reduced height

FREQUENCY RESPONSE/IMPEDANCE

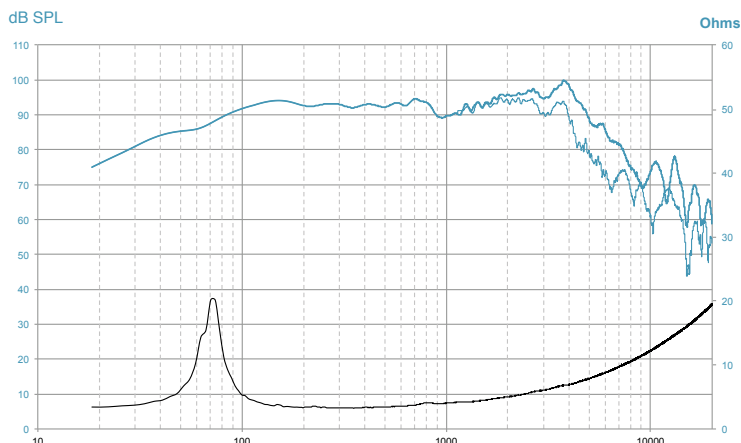

MECHANICAL DRAWING

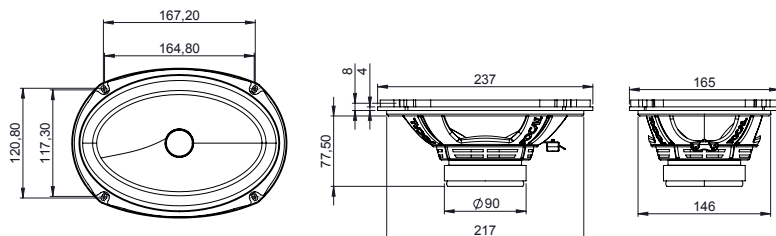

SPECIFICATIONS

Nominal power	80W	
Maximum power	160W	
Sensitivity (2.83V/1m)	93.6dB	
Cone	Polyglass	
Surround	Butyl	
Nom. impedance	4 Ohms	
DC resistance	3.2 Ohms	
VC diameter	30.5mm	0 ^{3/16} "
VC height	10.5mm	0 ^{7/16} "
Former	Kapton	
Layers	2	
Wire	Copper	
Inductance	0.16mH	
Xmax	2.75mm	0 ^{1/8} "
Magnet d x h	90 x 17mm	3 ^{9/16} x 0 ^{2/3} "
Magnet weight	320g	705.4 lb
Flux density	-	
Gap height	5mm	0 ^{3/16} "
Net weight	1250g	2.755 lb

PARAMETERS

Fs	54.33Hz
Vas	26.8 l
Qts	0.64
Qes	0.69
Qms	7.9
Re	3.28 Ohms
Sd	206.0cm ²
Cas	1.82 E-07m ⁵ /N
Mas	47.2kg/m ⁴
Ras	2039.440 Ohms.ac
Cms	450µm/N
Mms	19.08g
Rms	0.824kg/s
Ces	616.25mF
Les	13.93mH
Res	37.55 Ohms
BI	5.56N/A
SPL	89.7dB (Re)