

HARD WIRED REMOTE CONTROL INTERFACE  
 Adaptateur commande au volant / Stuurafstandsbediening / Lenkradbedienung

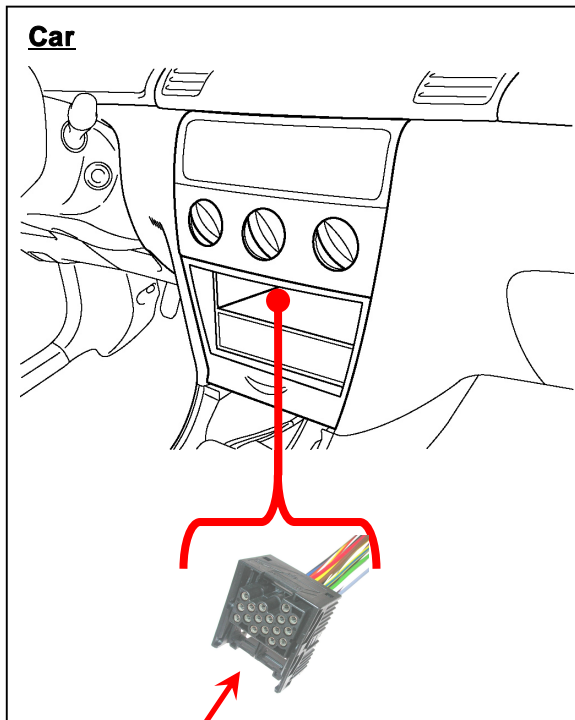

## ROVER

75 (06/99 → ...)

Discovery III (TD5) (03/'01 → ...)

Freelander (03/'01 → '03)

(with BMW loom)

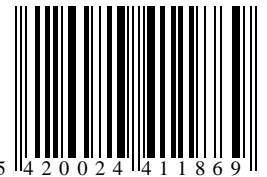

**Tools/Outils/Gereedschap/Werkzeug:**

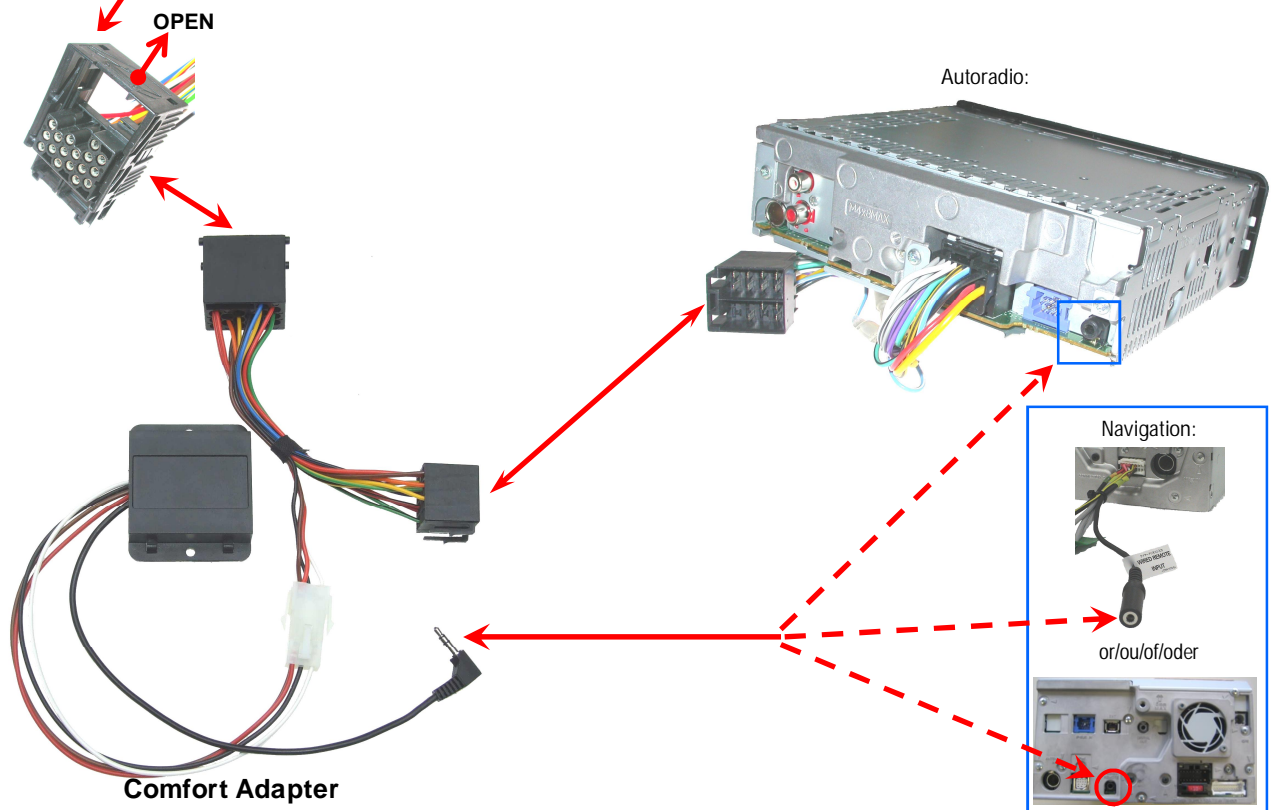

2 x



e 6  
020094

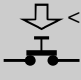
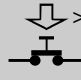

Subject to change in terms of construction, equipment and color, and may contain errors. The information and illustrations are non-binding.  
 Die Beschreibung kann von der tatsächlichen Ausstattung abweichen. Änderungen in der Ausstattung und der Farbe sowie Irrtum Vorbehalten. Daten und Abbildungen unverbindlich.  
 Wijziging met betrekking tot constructie, uitvoering en kleur evenals vergissingen voorbehouden. Gegevens en afbeeldingen niet bindend.  
 Sous réserve de modification de la construction, de l'équipement, de la couleur et sous réserve d'erreurs. Les indications et les illustrations sont sans engagement.

	 < 1S	 > 1S
<b>VOL (pull)</b>	<b>Volume +</b>	
<b>VOL (push)</b>	<b>Volume -</b>	
<b>MODE</b>	<b>Source</b>	<b>Mute</b>
	<b>Man. Freq + CD(C): Track +</b>	<b>Preset + CDC: Disc +</b>
	<b>Man. Freq - CD(C): Track -</b>	<b>Preset - CDC: Disc -</b>

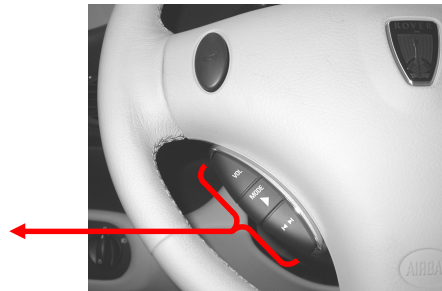

CD : only single CD  
 CDC : only multi CD (CD Changer)  
 CD(C) : CD & CDC

