

• **Suzuki Swift 2010->**

Compatible with these double DIN devices

**Pioneer Navigation**

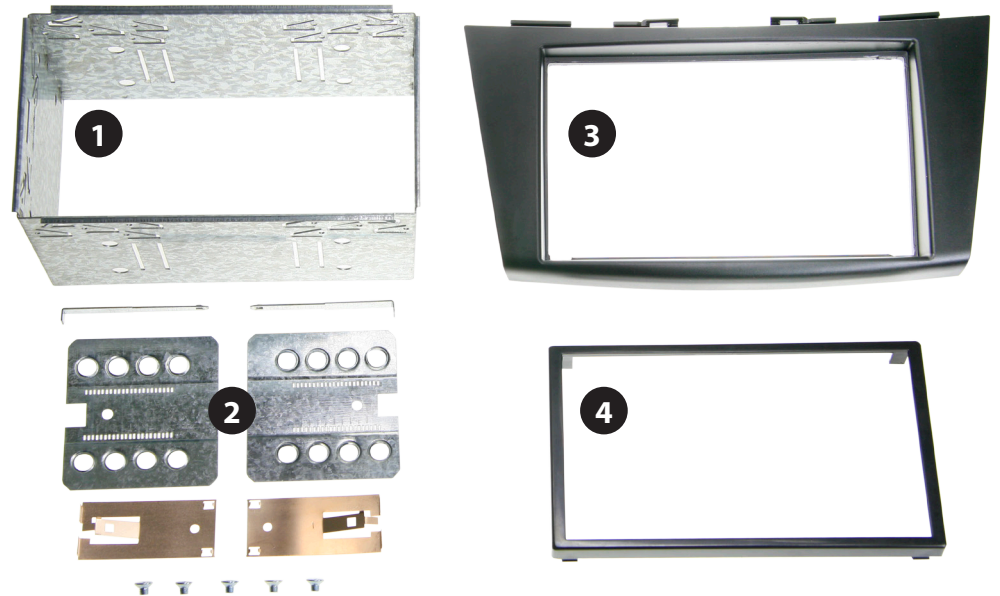

Double DIN Kit contents

- (1) Metal Frame
- (2) Installation Kit

- Installation Kit (3)
- Trim Frame (4)

## Installation Manual Double DIN Kit



1. Suzuki Swift OEM head unit



2. Lift up air vent unit (see arrows)



3. Unclip OEM head unit (see arrows)

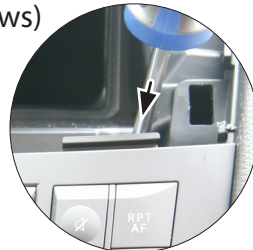

4. Remove OEM head unit



5. Push trim frame and fascia plate to metal frame until it snaps in.

Place it on dash board



6. Connect all required harness and circuit points. Push double DIN navigation into metal frame

*All installation work must be performed by a qualified professional installer only.  
The manufacturer / dealer is not liable for any kind of incidental or indirect damages.*