

**APPLICATIONS**

**2006 Honda Civic**

**KIT FEATURES**

- DIN Head Unit Provision with pocket
- ISO DIN Head Unit Provision with pocket
- Double DIN Head Unit Provision
- ISO Stacked Head Unit Provision
- Stacked DIN Head Unit Provision



**KIT COMPONENTS**

- A) Radio Housing   B) DDIN Trim Plate   C) ISO Trim Plate   D) Double DIN Brackets   E) Pocket  
F) (8) #8 Phillips Screws   G) ISO Brackets

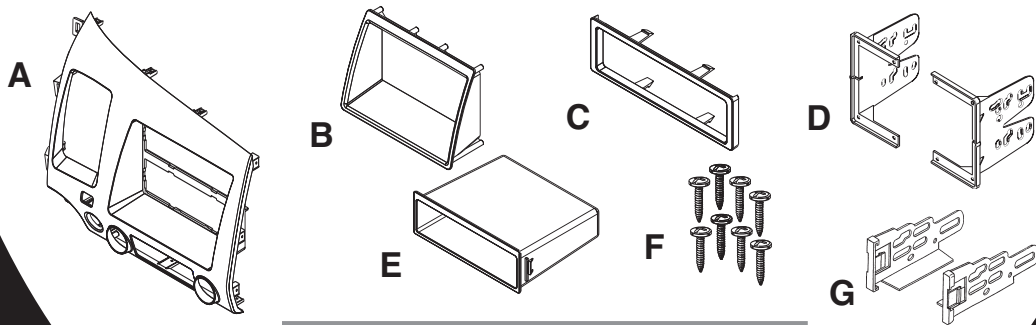

**TOOLS REQUIRED:**

Small Flat Screwdriver | Phillips Screwdriver | Socket Wrench



# **TABLE OF CONTENTS**

---

## **Dash Disassembly**

<b><i>2006 Honda Civic .....</i></b>	<b><i>1, 2</i></b>
--------------------------------------	--------------------

## **Kit Assembly:**

<b><i>DIN Head Unit Provision.....</i></b>	<b><i>3</i></b>
--	-----------------

<b><i>ISO DIN Head Unit Provision .....</i></b>	<b><i>4</i></b>
---	-----------------

<b><i>Double DIN Head Unit Provision .....</i></b>	<b><i>5</i></b>
--	-----------------

<b><i>Stacked ISO DIN Head Unit Provision.....</i></b>	<b><i>6</i></b>
--	-----------------

<b><i>Stacked DIN Head Unit Provision. ....</i></b>	<b><i>7</i></b>
---	-----------------

<b><u>Final Assembly .....</u></b>	<b><i>8</i></b>
------------------------------------	-----------------

## **2006 HONDA CIVIC**

- 1** Disconnect the negative battery terminal to prevent an accidental short circuit.
- 2** Unclip and remove the panel below the steering wheel. (Figure A)
- 3** Remove the (1) Phillips screw exposed on the lower left side of the panel above the steering wheel and around the instrument cluster. (Figure B)
- 4** Unclip and remove the panel around top of steering wheel and instrument cluster. (Figure C)
- 5** Remove panel inside pocket below radio and climate controls then remove (2) 8 MM screws facing up behind panel. (Figure D)

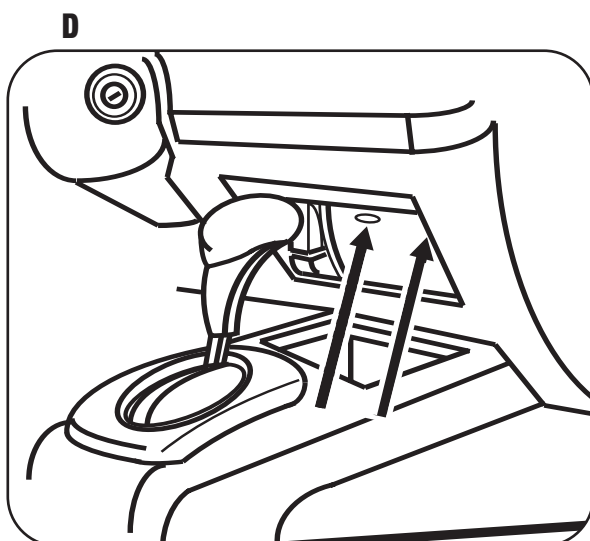
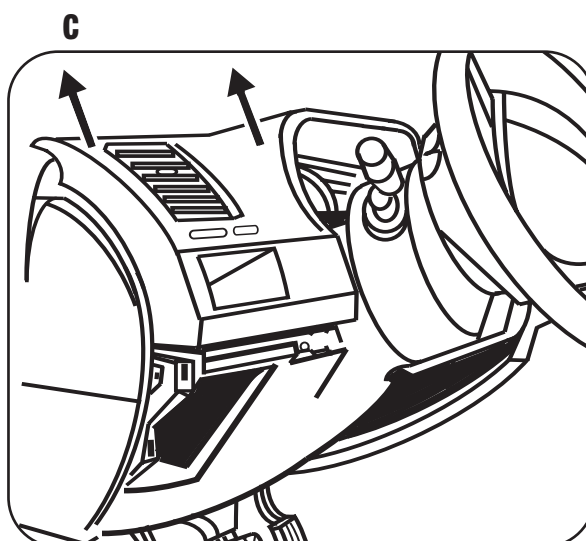
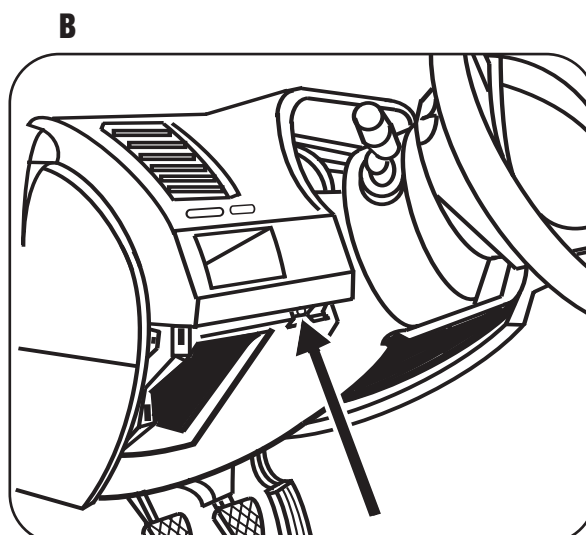
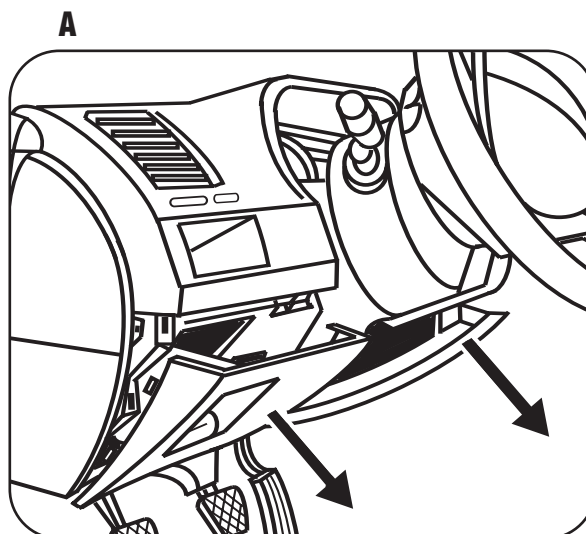

## 2006 HONDA CIVIC

- 6** Unclip and remove radio/climate control assembly. (Figure E)
- 7** Remove (3) Phillips screws securing the a/c vent to the radio/climate control panel. (Figure F)
- 8** Remove the (4) Phillips screws securing the climate control to the radio/climate control panel. (Figure F)
- 9** Remove the (2) Phillips screws securing the hazard switch to the radio/climate control panel. (Figure F)
- 10** Remove the (2) Phillips screws securing the passenger air bag on/off light to the radio/climate control panel. (Figure F)

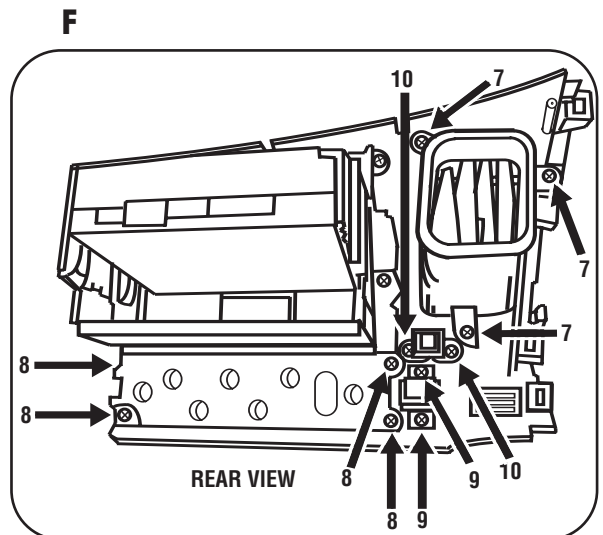
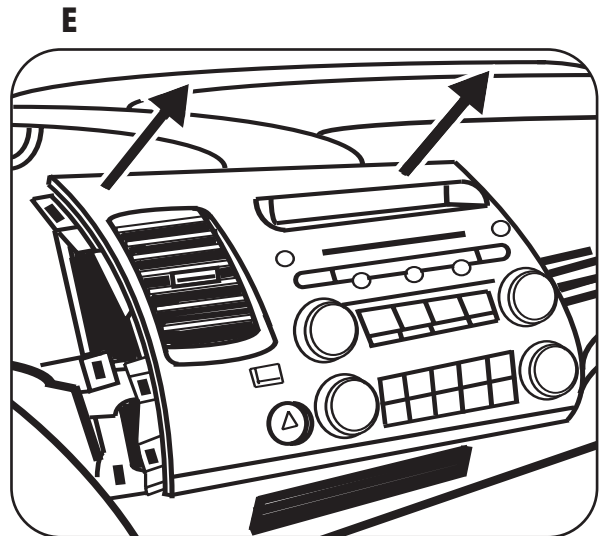

## **DIN HEAD UNIT PROVISION**

**NOTE:** Secure the a/c vent, climate control, hazard switch, and the passenger air bag on/off light into the radio housing panel using the factory hardware. (Figure A)

- 1** Slide the pocket into the bottom section of the kit housing. (Figure B)
- 2** Slide the DIN cage into the Radio Housing and secure by bending the metal locking tabs down. (Figure C)
- 3** Slide the aftermarket head unit into the cage and secure. (Figure D)

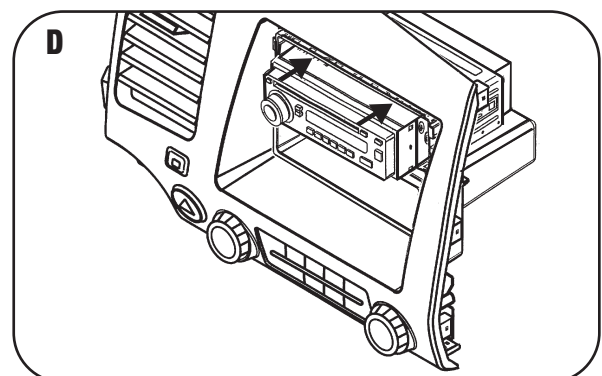
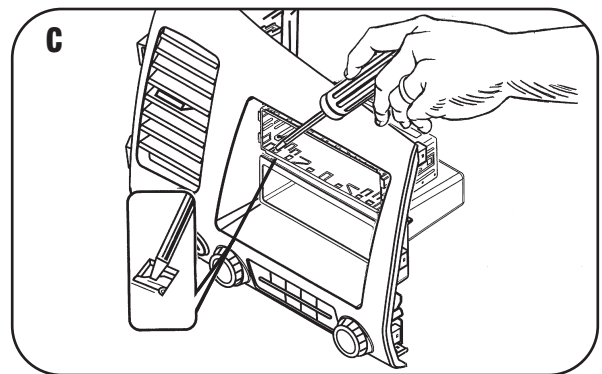
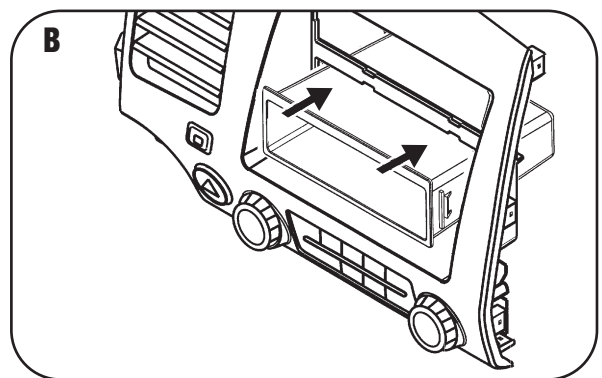
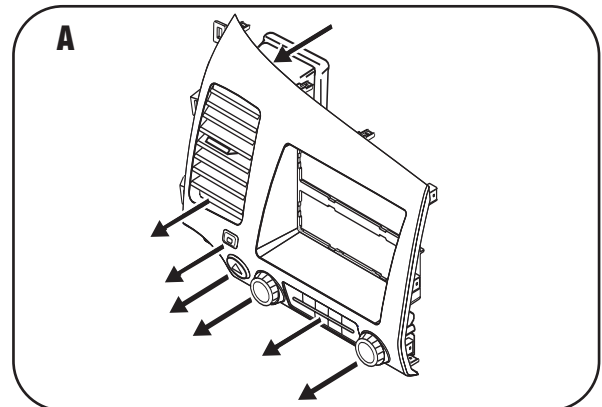

## ISO DIN HEAD UNIT PROVISION

**NOTE:** Secure the a/c vent, climate control, hazard switch, and the passenger air bag on/off light into the radio housing panel using the factory hardware. (Figure A)

- 1 Slide the pocket into the bottom section of the kit housing. (Figure B)
- 2 Mount the ISO Brackets to the head unit with the screws supplied with the unit. (Figure C)
- 3 Slide the head unit into the radio opening until the side clips engage. (Figure D)
- 4 Snap the Trim plate into the Radio Housing. (Figure D)

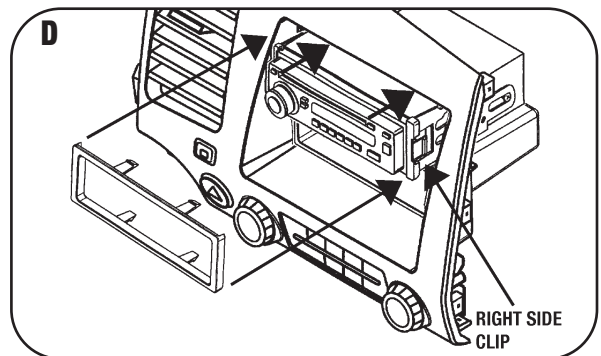
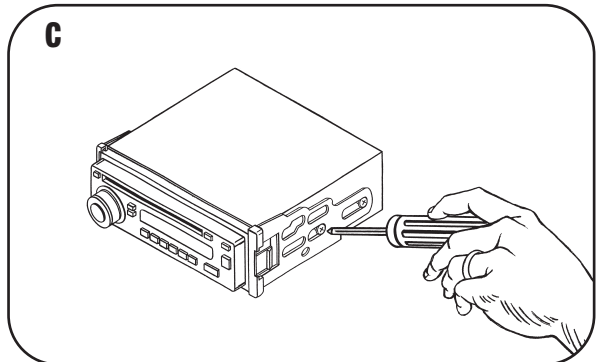
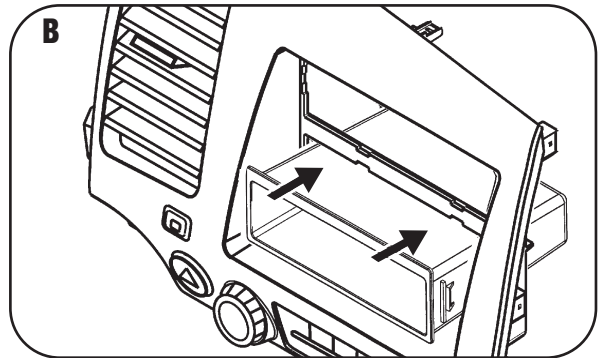
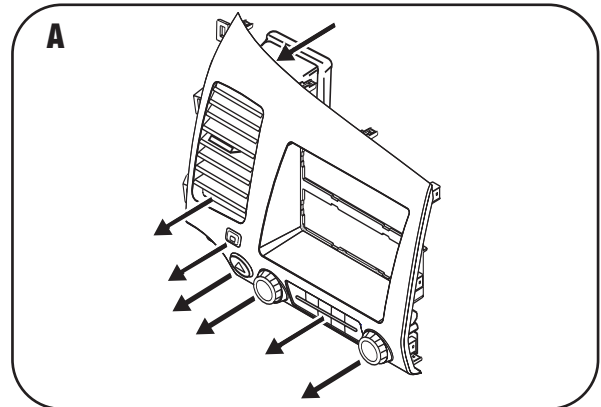

## **DOUBLE DIN HEAD UNIT PROVISION**

**NOTE:** Secure the a/c vent, climate control, hazard switch, and the passenger air bag on/off light into the radio housing panel using the factory hardware. (Figure A)

- 1** Remove the center bar from the radio housing. (Figure B)
- 2** Attach the corresponding bracket to the DDIN head unit. (Figure C)
- 3** Insert the DDIN trim plate into the radio housing. (Figure D)
- 4** Position the bracket/radio assembly to the back of the radio housing and secure with the (8) Phillips screws provided. (Figure D)

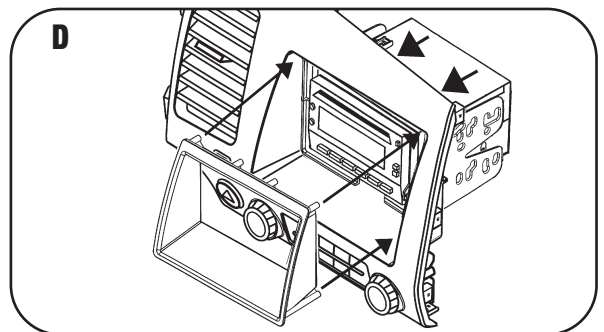
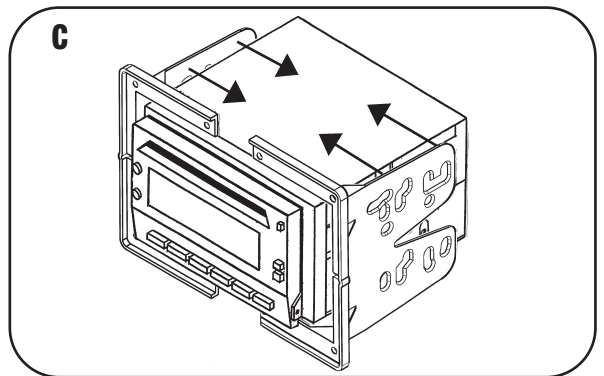
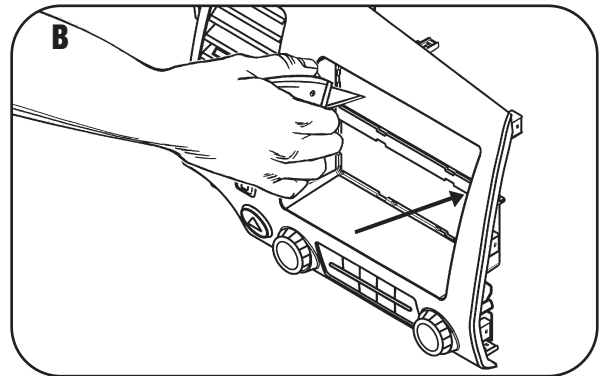
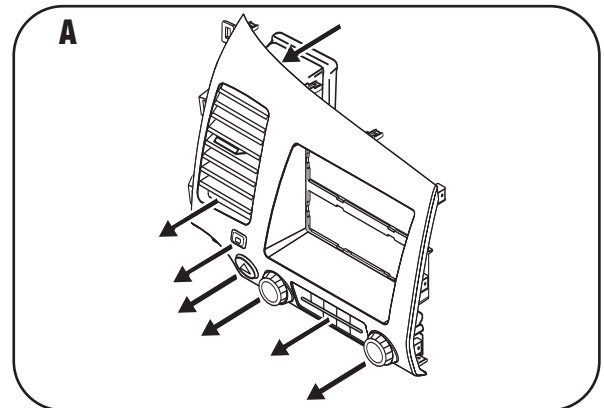

## **STACKED ISO DIN HEAD UNIT PROVISION**

**NOTE:** Secure the a/c vent, climate control, hazard switch, and the passenger air bag on/off light into the radio housing panel using the factory hardware. (Figure A)

- 1** Remove the center bar from the radio housing. (Figure B)
- 2** Attach the corresponding bracket to the (2) ISO head units. (Figure C)
- 3** Insert the DDIN trim plate into the radio housing. (Figure D)
- 4** Position the bracket/radio assembly to the back of the radio housing and secure with the (8) Phillips screws provided. (Figure D)

**A**

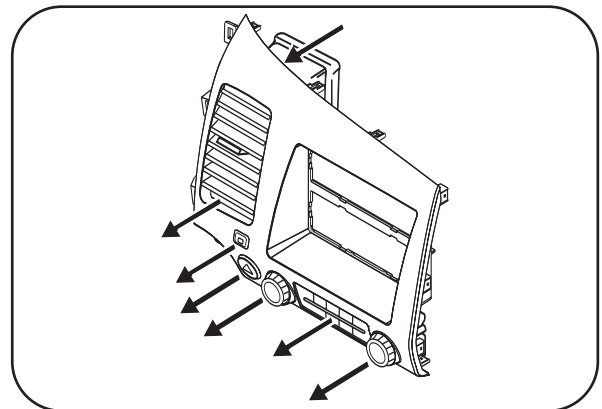

**B**

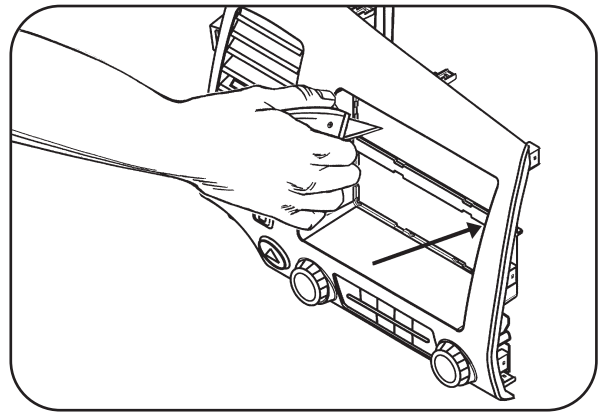

**C**

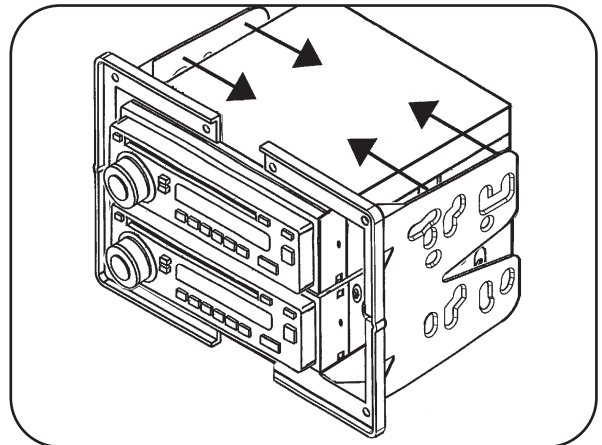

**D**

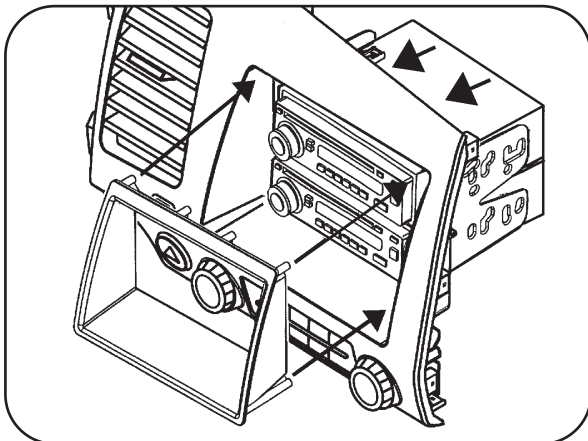



## **STACKED DIN HEAD UNIT PROVISION**

**NOTE:** Secure the a/c vent, climate control, hazard switch, and the passenger air bag on/off light into the radio housing panel using the factory hardware. (Figure A)

- 1** Slide the DIN cages into the Radio Housing and secure by bending the metal locking tabs outward. (Figure B)
- 2** Slide the aftermarket head units into the cages and secure. (Figure C)

**A**

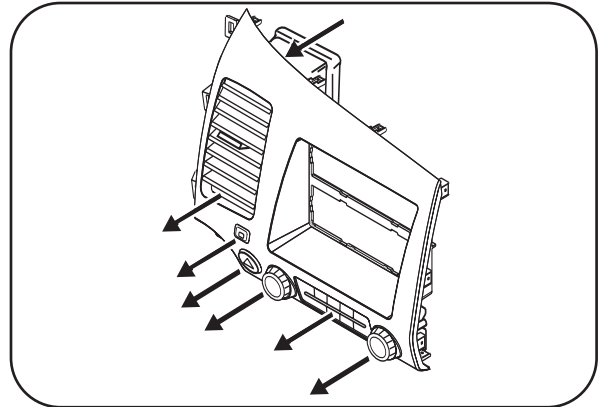

**B**

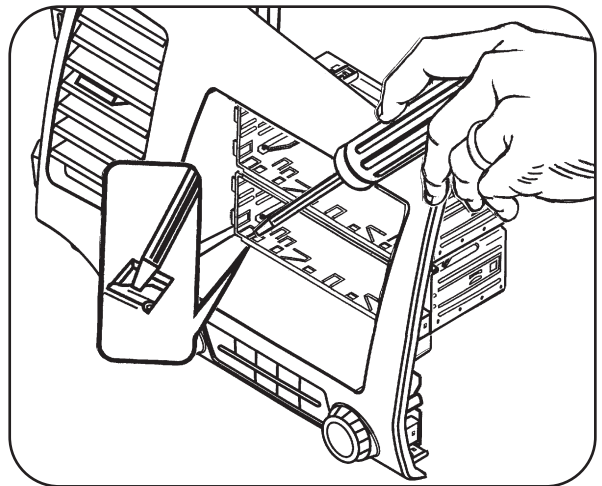

**C**

