

# 2-DIN 12.301034-01

## APPLICATIONS GM MULTI KIT

(see models list inside)



### KIT FEATURES

- Double DIN Mount Radio Provision
- Stacked ISO Mount Radio Provision

### KIT COMPONENTS

- A) Double DIN Housing • B) Double DIN Brackets

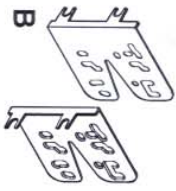

### TOOLS REQUIRED:

- Small Flat Blade Screwdriver/ Panel Removal Tool
- Phillips Screwdriver • Socket Set • Cutting Tool



## TABLE OF CONTENTS

<u>Dash Disassembly</u>	
<u>Chevrolet</u>	
- Cobalt 2005-2007	1
- Equinox 2005-2007	2
- IHR 2006-2007	3
- Malibu 2004-2007	4,5
<u>Pontiac</u>	
- G6 2005-2007	6
- Solstice 2006-2007	7
- Torrent 2006-2007	2
<u>Saturn</u>	
- Aura 2007	8
- Ion 2006-2007	9
- Sky 2006-2007	10
- Vue 2006-2007	11
<u>Kit Assembly</u>	
Double DIN Mount Radio Provision	12
Stacked ISO Mount Radio Provision	13
<u>Final Assembly</u>	14

### Note: (Malibu and G6 only)

The Driver Information Center and radio are one unit. Removal of the radio will prohibit the vehicle owner from programming any of the features of the Driver Information Center. However once the features are programmed the vehicle will retain all the settings.

Refer also to the instructions included with the aftermarket radio.

## Chevrolet Cobalt 2005-2007



1 Disconnect the negative battery terminal to prevent an accidental short circuit.

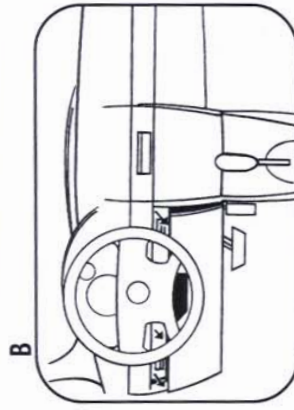

2 Unclip and remove trim panel from above glove box. (Figure A)

3 Unclip upper edge of panel below steering column and let hang. Not necessary to remove completely. (Figure B)

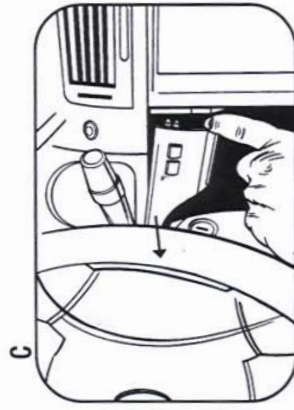

4 Unclip and remove small trim panel to right of ignition switch. (Figure C)



5 Unclip and remove trim panel surrounding radio and climate controls. (Figure D)



6 Remove (4) 9/32 screws securing radio. Unplug and remove the radio. (Figure E)

Continue to kit assembly.



## Chevrolet Malibu 2004-2007

- 1 Disconnect the negative battery terminal to prevent an accidental short circuit.
- 2 Unclip and remove wood grain/painted trim pieces from both sides of steering wheel. (Figure A)
- 3 Unclip and remove side panel from driver's side of dash with door open and remove (2) 7 MM screws. (Figure B)
- 4 Remove (2) 7 MM screws from bottom edge of panel below steering wheel, unclip panel and let hang. It is not necessary to completely remove panel. (Figure C)
- 5 Unclip and remove wood grain/painted trim piece from above glove box. (Figure D)

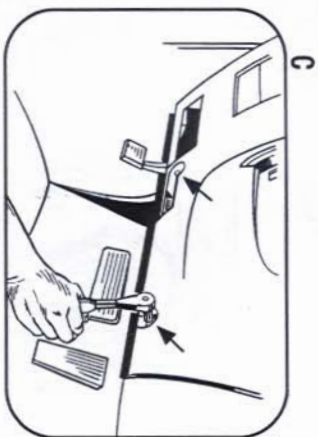
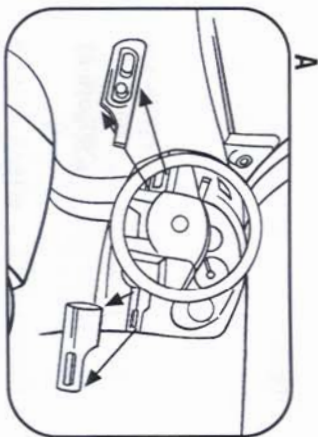

4

## Chevrolet Malibu 2004-2007

- 6 Unclip and remove side panel from passenger side of dash with door open and remove (2) 7 MM screws from behind panel. (Figure E)
- 7 Remove (2) 7 MM screws from bottom of glove box then open box and squeeze sides together to open further and remove the remaining (4) 7MM screws. Unclip the black vent cover under the glove box then unclip and remove entire glove box assembly. (Figure F)
- 8 Unclip and remove trim panel surrounding radio and climate controls. (Figure G)
- 9 Remove (4) 7 MM screws securing the radio and (2) 7 MM screws securing the climate control. Unplug and remove the radio. (Figure H)

*Continue to kit assembly.*

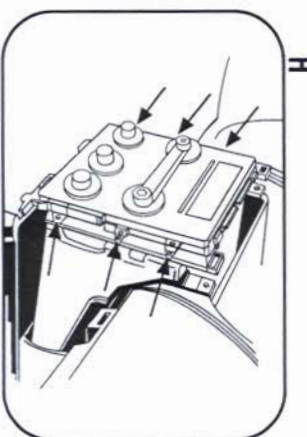
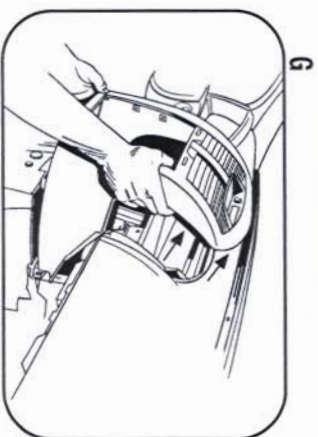
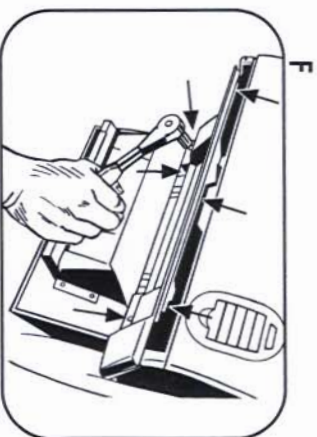

5

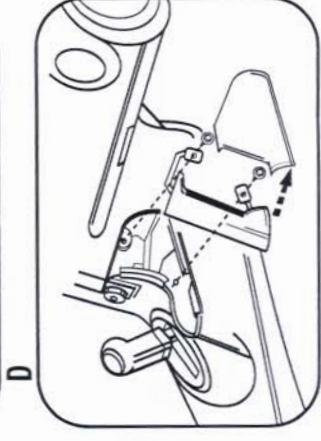
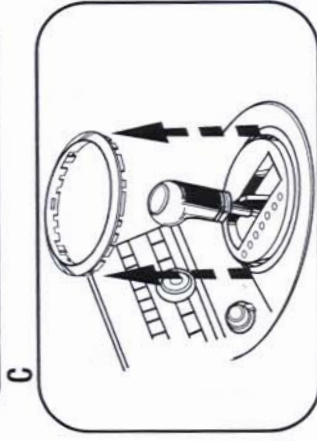
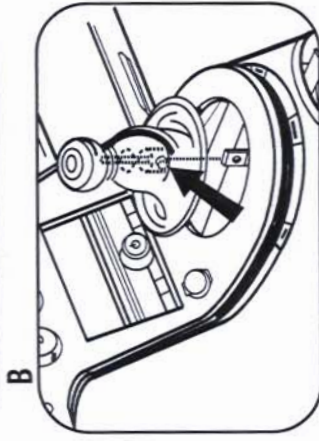
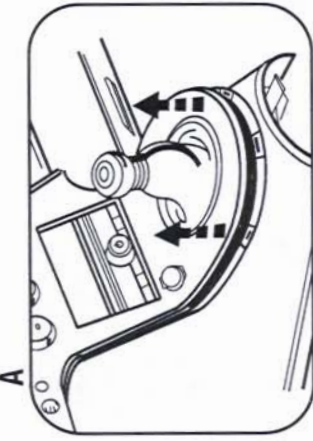

1 Disconnect the negative battery terminal to prevent an accidental short circuit.

**2 Manual transmission:**

A. Lift up the lower edge of the instrument panel cluster trim plate enough to reach underneath and release the shift boot trim ring retaining tabs. **(Figure A)**

B. Lift up on the shift boot and loosen the setscrew to release the shift lever. **(Figure B)**

**2 Automatic transmission:**

A. Unclip and remove shifter trim ring. **(Figure C)**

3 Unclip and remove passenger assist handle trim panel. **(Figure D)**

4 Remove (2) bolts securing the passenger assist handle and remove handle. **(Figure D)**

5 Unclip and remove dash trim panel.

6 Remove (4) screws securing the radio. Unplug and remove the radio.

*Continue to kit assembly.*

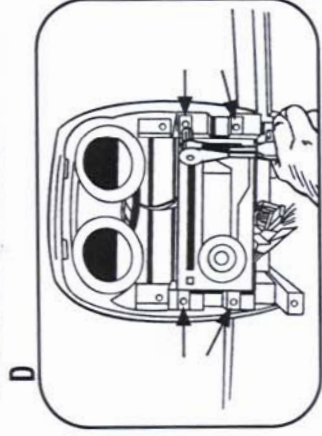
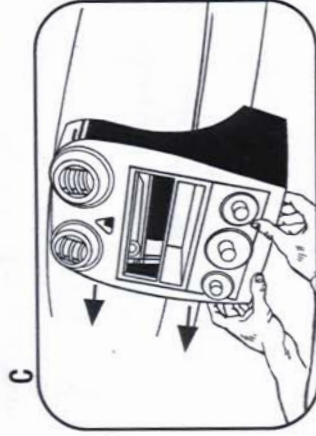
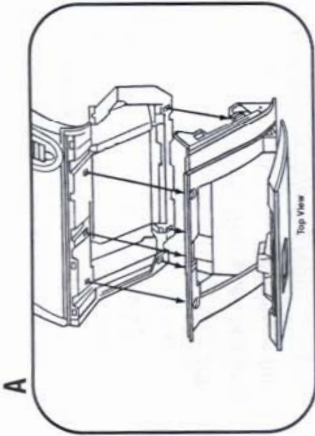

1 Disconnect the negative battery terminal to prevent an accidental short circuit.

2 Open glove box and remove (6) screws from outer edge then unclip and remove box. **(Figure A)**

3 Remove (4) screws from panel below steering column. Unclip and remove panel. **(Figure B)**

4 Unclip and remove center panel surrounding radio and A/C controls. **(Figure C)**

5 Remove (4) screws securing the radio. Unplug and remove the radio. **(Figure D)**

*Continue to kit assembly.*

- 1 Disconnect the negative battery terminal to prevent an accidental short circuit.
- 2 Unclip and remove shifter trim ring. (Figure A)
- 3 Unclip and remove the center console trim panel, then remove (2) screws from bottom edge of dash trim panel. (Figure B)
- 4 Unclip and remove the key switch trim ring, then unclip and remove dash trim panel. (Figure C)
- 5 Remove (2) screws securing the climate controls.
- 6 Remove (4) screws securing the radio. Unplug and remove the radio.

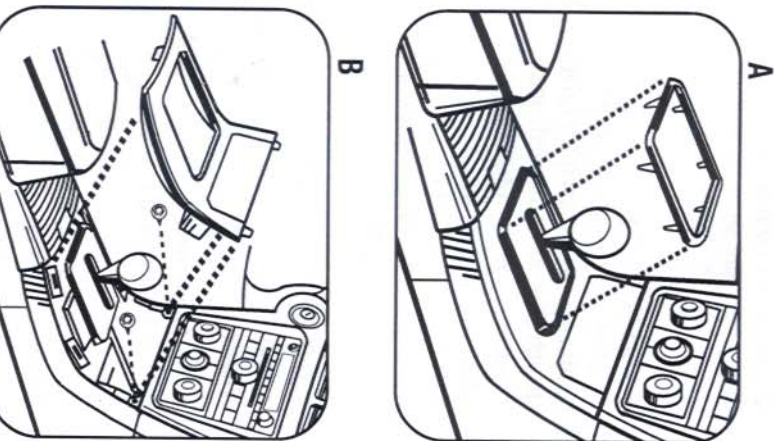

**8**

- 1 Disconnect the negative battery terminal to prevent an accidental short circuit.
  - 2 Unclip radio trim panel. (Figure A) Unplug connectors from trim panel and remove panel. (Figure B)
  - 3 Remove (4) screws securing the radio. Unplug and remove the radio.
- Continue to kit assembly.*

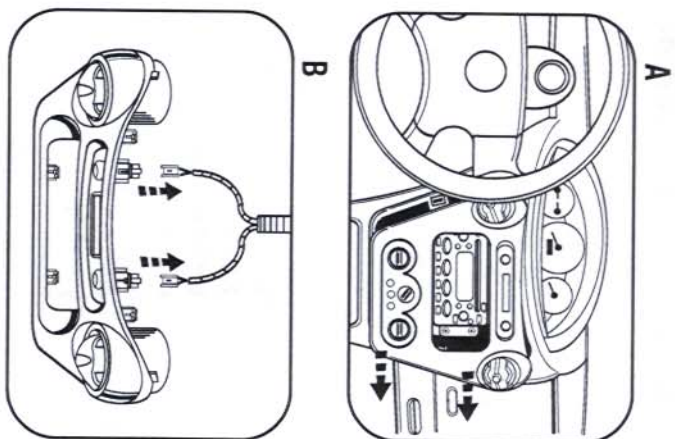

**9**

## Saturn Sky 2006-2007

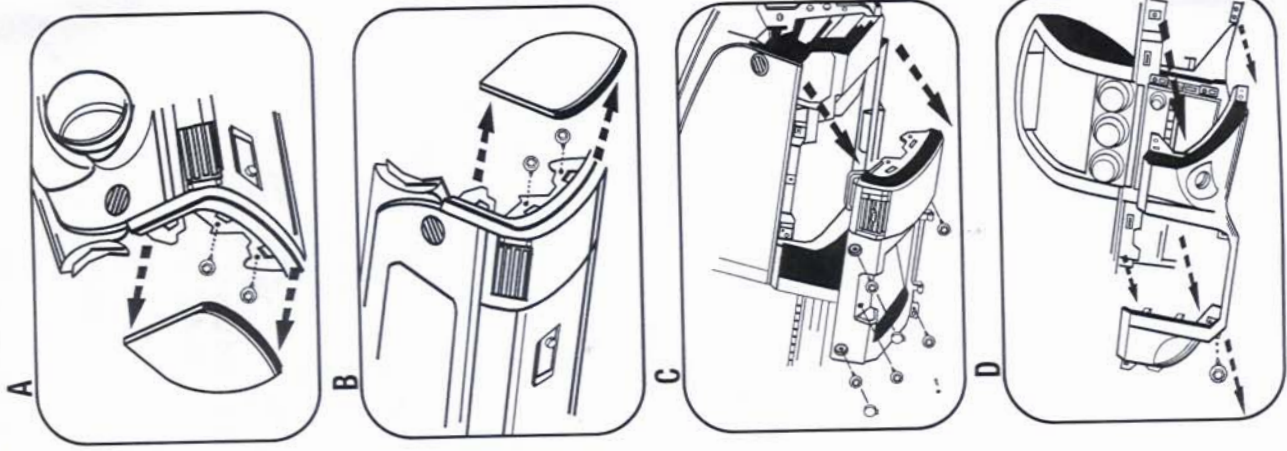

- 1 Disconnect the negative battery terminal to prevent an accidental short circuit.
- 2 Unclip and remove side panel from driver's side of dash with door open and remove (2) 7 MM screws. (Figure A)
- 3 Remove (2) 7 MM screws from bottom edge of panel below steering wheel, unclip panel and remove panel.
- 4 Unclip and remove side panel from passenger side of dash with door open and remove (2) 7 MM screws from behind panel. (Figure B)
- 5 Open the glove box and disconnect the glove box dampener from the glove box assembly. Squeeze sides together to open further. (Figure C)
- 6 Remove (2) bolt covers from top edge of glove box frame. (Figure C)
- 7 Remove (5) bolts from glove box frame and remove frame. (Figure C)
- 8 Remove (1) screw from lower left corner of radio trim panel and unplug connectors to remove panel. (Figure D)
- 9 Remove (4) screws securing the radio. Unplug and remove the radio. Continue to kit assembly.

## Saturn Vue 2006-2006

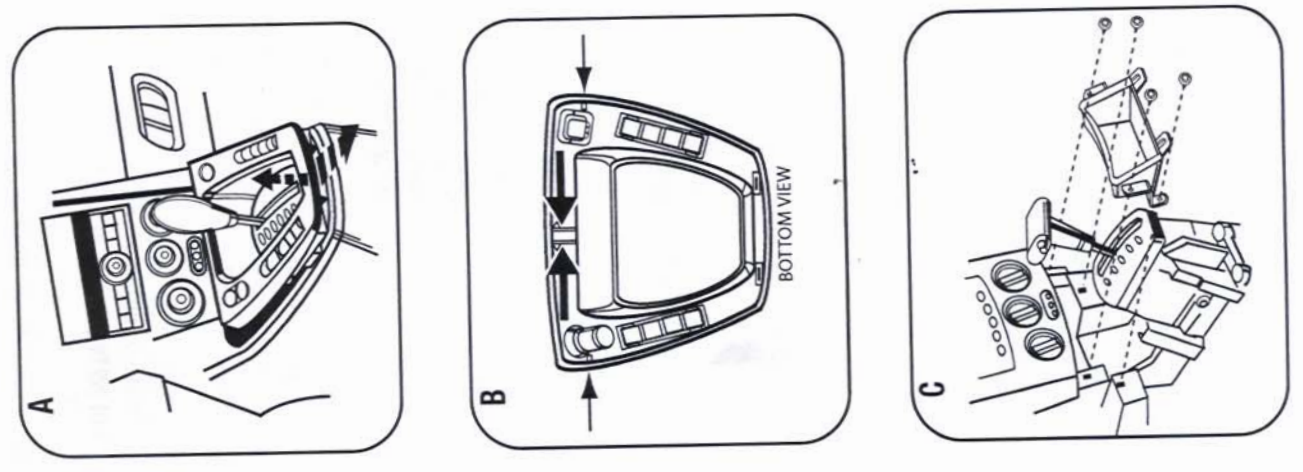

- 1 Disconnect the negative battery terminal to prevent an accidental short circuit.
- 2 Grasp the front edge of the shifter trim panel and pull outward and upward. (Figure A)
- 3 Squeeze the locking tabs located at the front edge of the shifter trim panel together to release the front edge of the panel from the center console. (Figure B)
- 4 Pull upward on the panel to release the remaining clips, and remove trim panel.
- 5 Remove (4) screws securing storage pocket and remove pocket. (Figure C)
- 6 Unclip and remove center dash trim panel. (Figure D)
- 7 Remove (4) screws securing the radio. Unplug and remove the radio. Continue to kit assembly.

Continue to kit assembly.

## DOUBLE DIN MOUNT RADIO PROVISION

*\*Note: Refer also to the instructions included with the aftermarket radio.*

- 1 Slide the appropriate bracket into the trim plate aligning the holes in the trim plate to the clips on the bracket. (Figure A)
- 2 Slide the DDIN radio unit into the trim plate bracket assembly and secure the unit to the kit using the screws supplied with the head unit. (Figure B)
- 3 **Aura, HHR, Sky and Vue only:**  
Cut and remove top mounting tabs on each side of the Radio Housing. (Figure C)

*Continue to final assembly.*

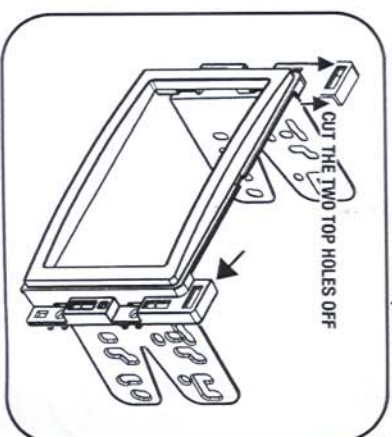
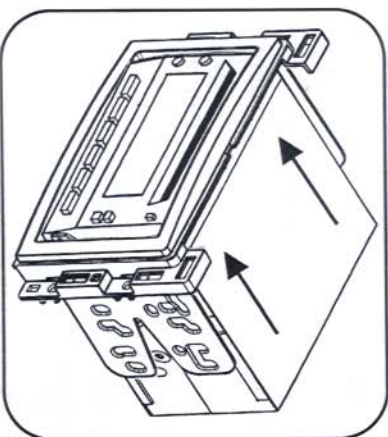
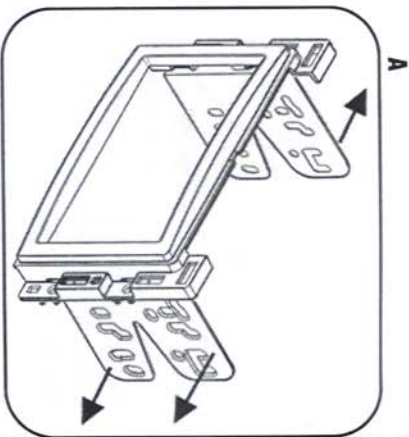

12

## STACKED ISO MOUNT RADIO PROVISION

*\*Note: Refer also to the instructions included with the aftermarket radio.*

- 1 Slide the appropriate bracket into the trim plate aligning the holes in the trim plate to the clips on the bracket. (Figure A)
- 2 Slide the stacked ISO DIN units into the trim plate bracket assembly and secure the units to the kit using the screws supplied with the head units. (Figure B)
- 3 **Aura, HHR, Sky and Vue only:**  
Cut and remove top mounting tabs on each side of the Radio Housing. (Figure C)

*Continue to final assembly.*

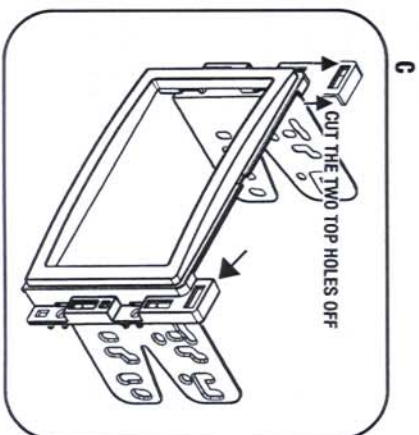
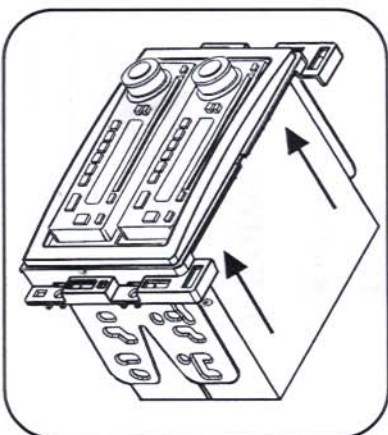
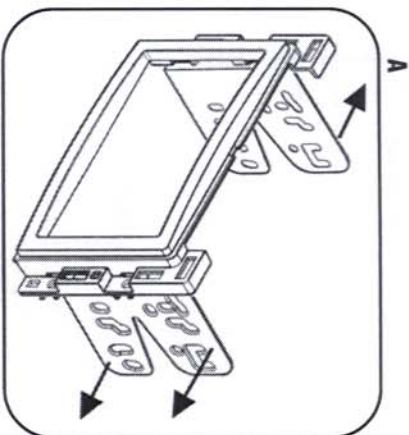

13