

EVO 260 - suggested boxes (page 1 of 2)

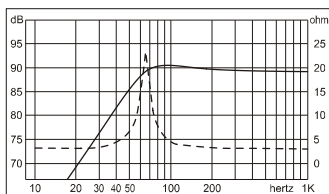

CLOSED BOX (small)
 range: 50 ÷ 120 Hz
 sensitivity: 88 dB @ 55 Hz
 volume: 13 litres

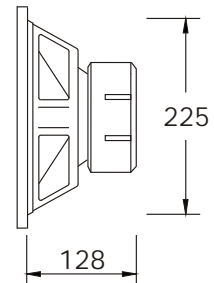
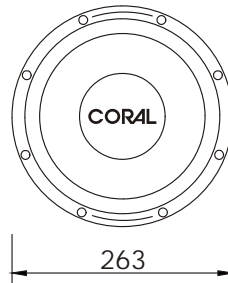
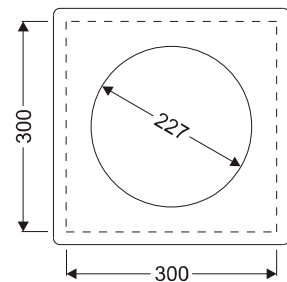
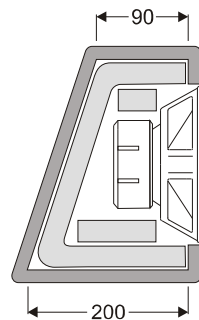
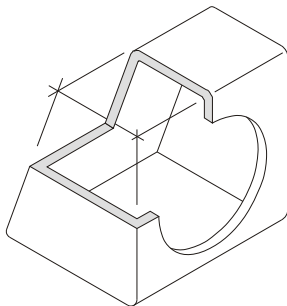

■ materiale fonoassorbente / *sound-absorbing material*

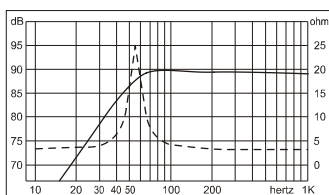

CLOSED BOX (large)
 range: 45 ÷ 120 Hz
 sensitivity: 88 dB @ 55 Hz
 volume: 17 litres

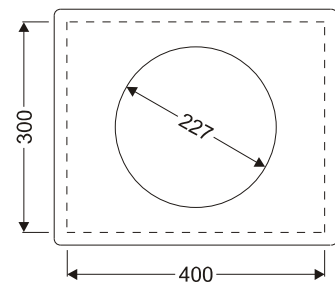
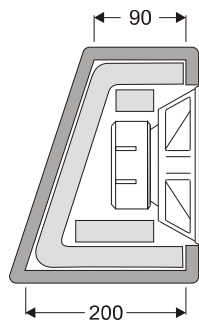
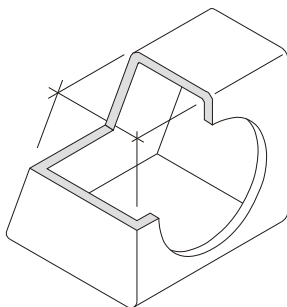

■ materiale fonoassorbente / *sound-absorbing material*

EVO 260 - suggested boxes (page 2 of 2)

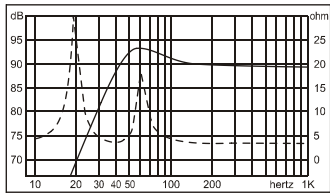

REFLEX BOX (small)

range: 37 ÷ 120 Hz
 sensitivity: 93 dB @ 55 Hz
 tube: Ø 74 x 170 mm
 volume: 28 litres

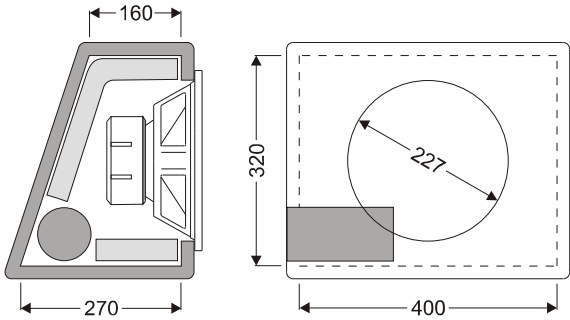
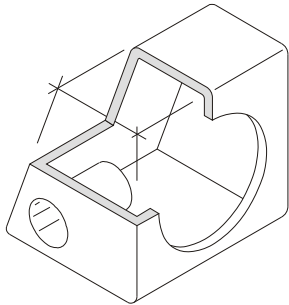

■ materiale fonoassorbente / *sound-absorbing material*

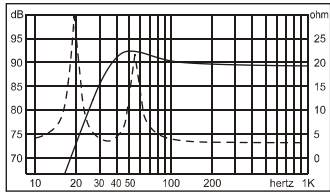

REFLEX BOX (large)

range: 31 ÷ 120 Hz
 sensitivity: 92 dB @ 48 Hz
 tube: Ø 74 x 170 mm
 volume: 38 litres

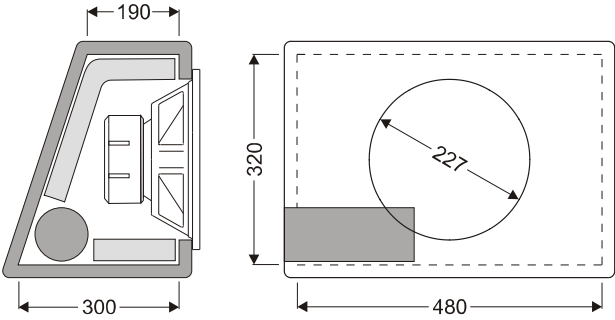
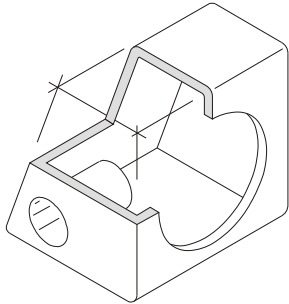

■ materiale fonoassorbente / *sound-absorbing material*

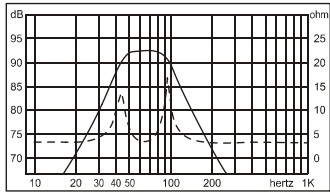

BAND-PASS BOX

range: 42 ÷ 100 Hz
 sensitivity: 92 dB @ 50 Hz
 tube: Ø 94 x 170 mm
 Vc/Vb volume: 17/15 litres

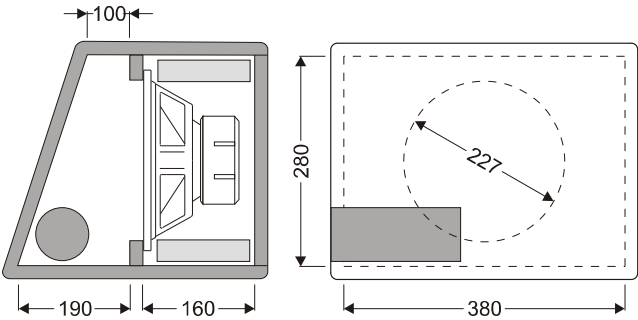
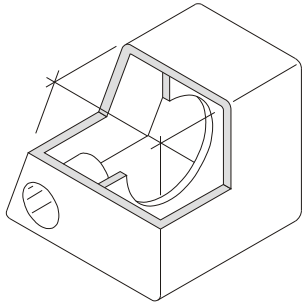

■ materiale fonoassorbente / *sound-absorbing material*